



California Faucets®

Corsano®

Hot Only Water Dispenser

Features

- 25+ artisan finishes including 10+ PVD finishes
- All brass construction
- Insulated spout to reduce heat to faucet
- Max flow rate: 1.0 gpm (3.8 L/min)
- Self-Closing handle
- Compatible with RO filter unit
- Requires Hot Water Tank (9628SS) sold separately

Codes/Standards Applicable

Product meets or exceeds the following:

- ASME A112.18.1/CSA B125.1
- NSF 61, NSF 372, CEC & DOE
- Commonwealth of MA
- ADA compliant



9625-K51-FB shown

9625-K51-BFB
9625-K51-BST
9625-K51-FB
9625-K51-ST



XX = DENOTES
HANDLE STYLE

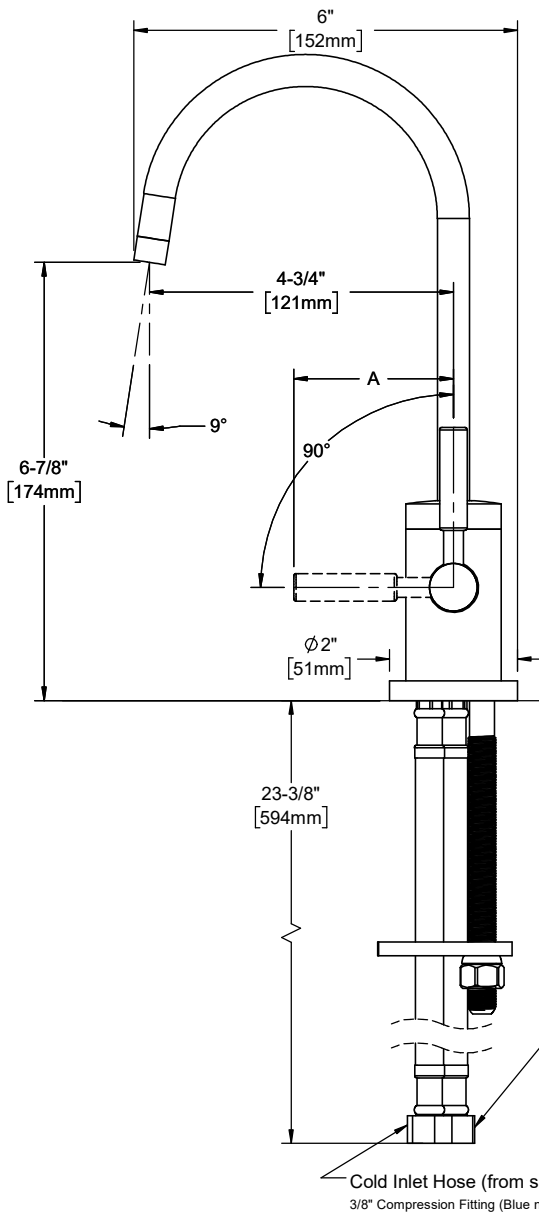

Through-Hole Specifications

Min	Recommended	Max
Ø 1-1/4" [32]	Ø 1-3/8" [35]	Ø 1-1/2" [38]

Dimensions (in.)

Handle XX	A	B
FB BFB	2-1/2" [64mm]	4-5/16" [109mm]
ST BST	2-1/2" [63mm]	4-1/4" [108mm]

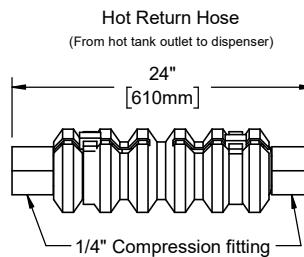

Tank Inlet Hose (To hot tank inlet)
3/8" Compression Fitting (Red nut)

Cold Inlet Hose (from supply stop)
3/8" Compression Fitting (Blue nut)

	Couplings are to be used on hot tank
	1 @ 1/4" Tank outlet to hot return hose
	1 @ 3/8" Tank inlet to tank inlet hose



Supply line flow restrictor
for 3/8" compression fitting
9/16"-24 male x female

Specifications subject to change without notice

Dimensions are inches, rounded to 1/16"
[Dimensions in brackets are mm, rounded to 1mm]