



California Faucets®

VL-R Vessel Rough Valve Installation Instructions

CALIFORNIA FAUCETS RECOMMENDS THAT ALL PLUMBING PRODUCTS BE INSTALLED BY A LICENSED PROFESSIONAL

IMPORTANT: Read all instructions prior to installation and provide copy of instructions to consumer.

Operating Specifications:

Recommended Supply Pressure: 20 to 70 psi [1.4 to 4.8 bar] **

* Operating pressures between hot and cold supplies should vary no more than 30 psi [2.1 bar].

† If water pressure exceeds 70 psi [4.8 bar], install a Pressure-Reducing Valve (PRV).

1 INSTALLING VALVE

- Install BRACING (2) (2x4 stud recommended) at desired height and depth

IMPORTANT: Refer to table in DIMENSIONS section for desired depth depending on trim series dimensions, "A" and "B".

- Secure VALVE (1) to BRACING (2) using SCREW (3) (not supplied)

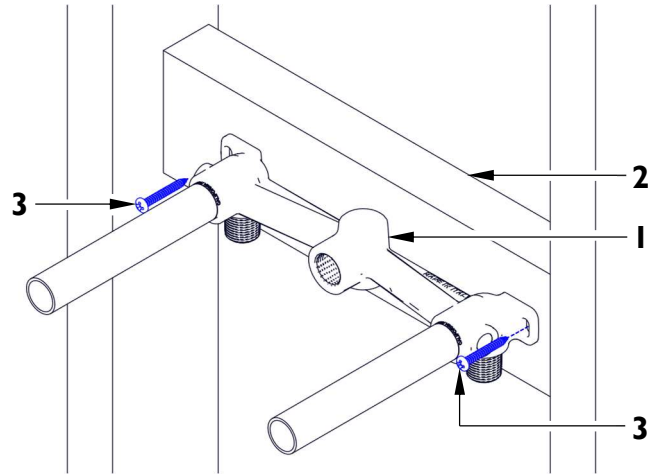

2 SUPPLY CONNECTIONS

NOTE: Use thread sealant (not supplied) on all threaded connections; do **NOT** exceed more than 3 wraps of Teflon tape.

- Pre-assemble all FITTINGS (6) with thread sealant (not supplied) prior to attaching to VALVE (1)
- Connect hot supply to HOT INLET (1a) and connect cold supply to COLD INLET (1b)

IMPORTANT: Flush supply lines prior to installation to prevent damage and malfunction of cartridge.

WARNING: All soldering of fittings shall be performed a minimum of 4" away from VALVE (1).

- To check for leaks, install 1/2" NPT PLUG (4) (not supplied) into SPOUT OUTLET (1c)
- Turn on water supply to valve
- Remove MUDGUARDS (5)
- To open valve, turn STEM (1d) clockwise (CW) for hot supply and STEM (1e) counterclockwise (CCW) for cold supply
- Check all connections for leaks

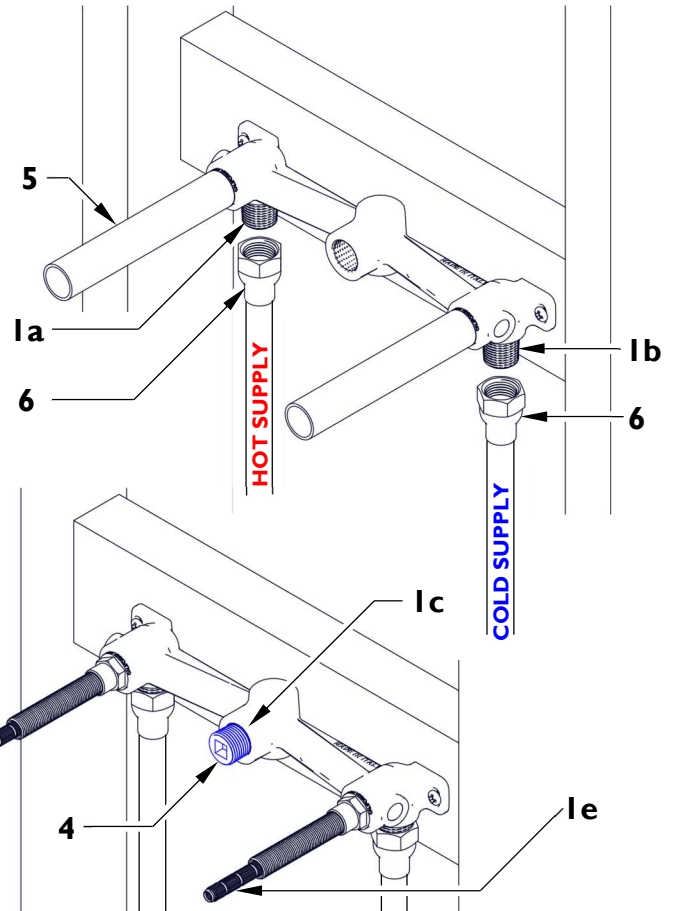

3

DIMENSIONS

NOTE: When fitting HANDLE, it may be necessary to shorten STEM and/or ALL-THREAD to eliminate gap between HANDLE & ESCUTCHEON.

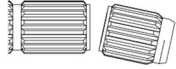

Series	A" [mm]	B" [mm]
30	1-3/4" [44]	7/8" [22]
33, 35	2-1/2" [64]	1-1/2" [38]
34	2-7/16" [62]	1-1/2" [38]
37, 38	1-1/16" [27]	1/4" [6]
39	1-3/8" [35]	3/16" [5]
40	1-1/16" [27]	3/16" [5]
41	1-1/8" [29]	3/16" [5]
45	2" [51]	1-1/8" [29]
46, 47	2-5/16" [59]	1-1/2" [38]
48	2-3/8" [60]	1-5/8" [41]
52, 53	1-3/8" [35]	1-1/8" [29]
56	2-3/8" [60]	1-9/16" [40]
60, 61	2-1/4" [57]	1-1/2" [38]
62	13/16" [20]	1/4" [6]
65, 66	1-7/8" [48]	1-1/8" [28]
**70	1-3/8" [35]	3/4" [19]
**74	3/4" [19]	3/16" [5]
**77, 78	1-5/16" [33]	5/8" [16]
**77R, 78R	1-1/8" [29]	5/8" [16]
80	1-9/16" [40]	7/8" [22]
85	1-1/2" [38]	3/4" [19]
87	1-1/4" [32]	3/8" [9]
C1	1-3/8" [35]	5/8" [16]
**C2	1-3/8" [35]	3/8" [10]
**E3	1-1/8" [29]	1/4" [6]
**E4	7/8" [22]	1/4" [6]
**E5	7/8" [22]	1/4" [6]

****NOTE:** Valve rough must be set back a minimum of 3-3/8" [84mm] from finished wall surface to bracing surface.

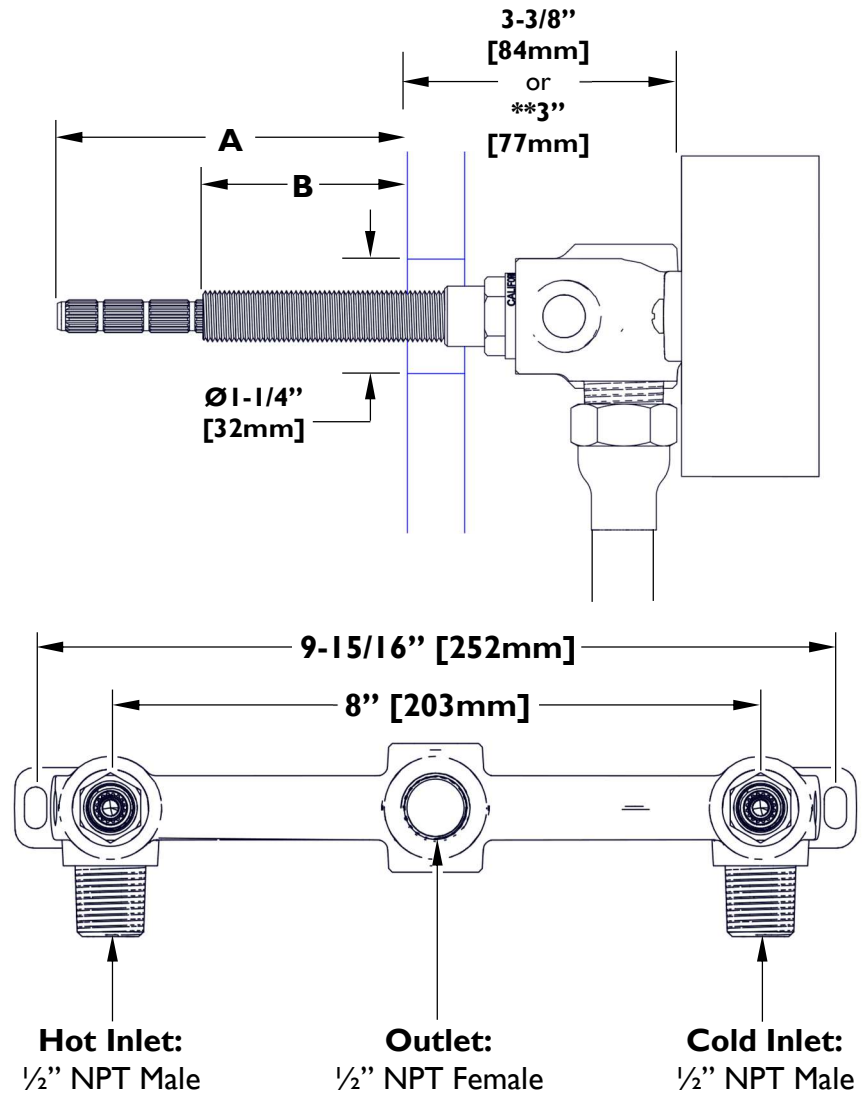

4

RE-ALIGNING CARTRIDGE

IMPORTANT: Shut off water supply before starting.

- Slightly loosen in a CCW direction the cartridge NUT (7). Place HANDLE (9) on STEM (8) and tighten in a CW direction until desired alignment of handle is achieved. Retighten cartridge NUT (7) to factory torque setting of 14 lb-ft [19.0 Nm]

WARNING: Cartridge NUT (6) must be properly torqued to prevent possible failure and/or water damage.

