

## Shower Door Towel Bar & Handle Installation Instructions

**CALIFORNIA FAUCETS RECOMMENDS THAT ALL PLUMBING PRODUCTS BE INSTALLED BY A LICENSED PROFESSIONAL**

**IMPORTANT:** Read all instructions prior to installation and provide copy of instructions to consumer.

### 0 GLASS PANE REQUIREMENTS

- Glass thickness shall be 3/8" [10mm] to 1/2" [13mm]
- All through-holes must be Ø1/2" [13mm] in diameter
- See table below for correct distances between through-hole centers

SKU	A [mm]	B [mm]
SD-TBH-XX-18-08	18" [457]	8" [203]
SD-TBH-XX-18-12	18" [457]	12" [305]
SD-TBH-XX-24-08	24" [610]	8" [203]
SD-TBH-XX-24-12	24" [610]	12" [305]

"XX" represents series

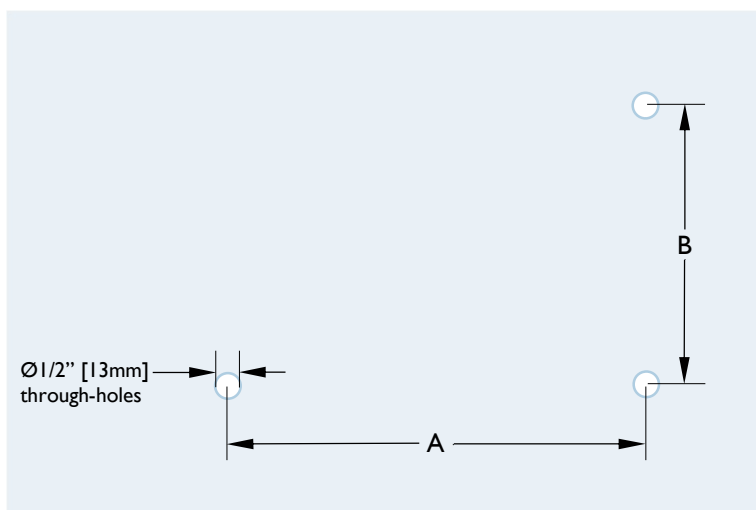

### I INSTALLING 1ST COVER PLATE

**IMPORTANT:** Ensure that there is always an O-RING (2) on every BASE RING (3) and COVER (1) when mounting to glass pane.

**NOTE:** BASE RING o-ring groove shall be towards glass

**NOTE:** There are two 1/4"-20 SCREW lengths:

SCREW (3) = 1" [25mm] long

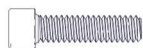

SCREW (8) = 1-1/2" [38mm] long

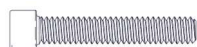

Screws MUST NOT be switched

- Place O-RING (2) into groove of COVER (1)
- Insert COVER (1) into through-hole shown in image
- Place O-RING (2) into groove of BASE RING (5)
- Secure PLUG (4) & BASE RING (5) by tightening SCREW (3) into COVER (1) using HEX KEY (6)

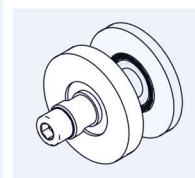
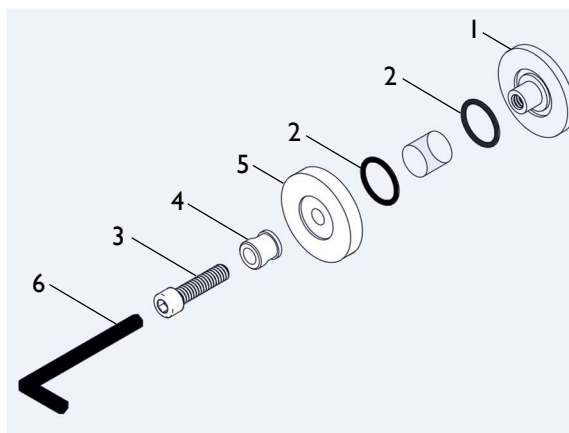
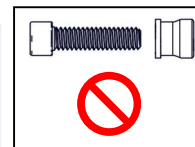
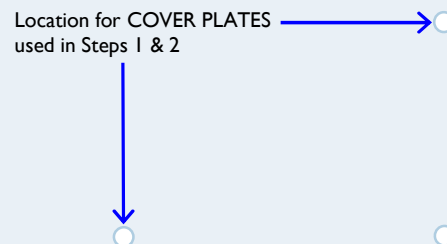
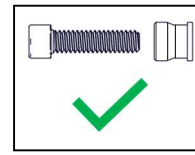
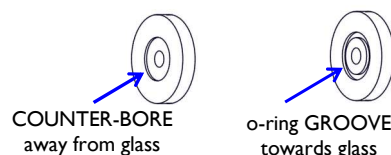

## 2

### INSTALLING 2ND COVER PLATE

- Repeat Step 1 on other through-hole from other side of glass

**NOTE:** COVERS (1) shall be installed on opposite sides of glass

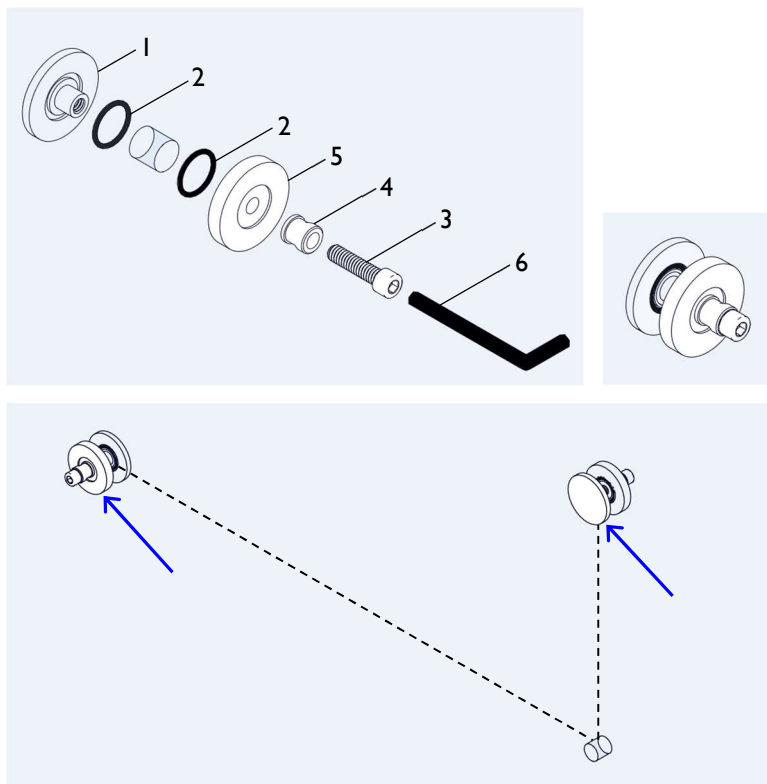

## 3

### MOUNTING INSIDE HANDLE

- Place O-RINGS (2) into GROOVE of BASE RINGS (5)
- Place POST (7a) onto PLUG (4) temporarily tighten SETSCREW (7c) using HEX KEY (9)
- Place BASE RING (5) over through-hole and under POST (7b)

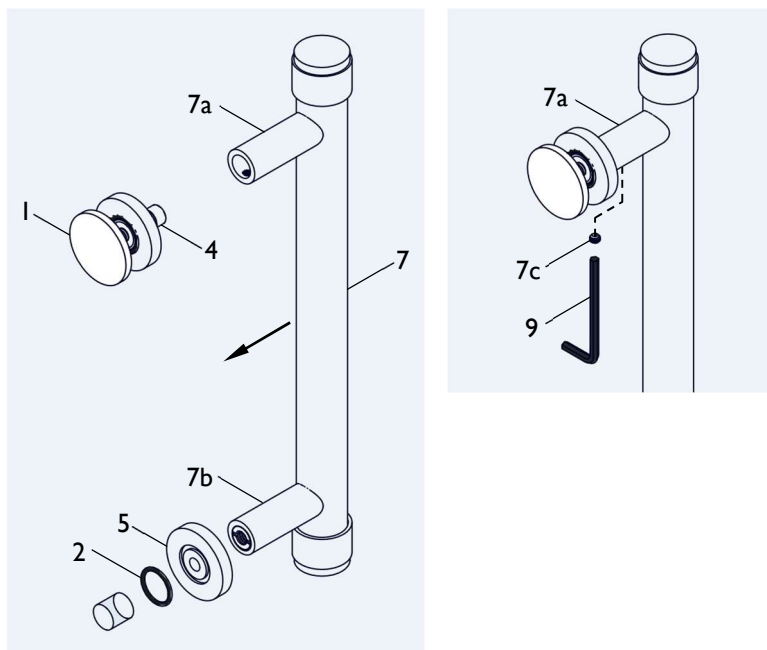

- Secure PLUG (4) and BASE RING (5) by tightening SCREW (8) into POST (7b) using HEX KEY (6)
- If necessary, loosen SETSCREW (7c) to align POST (7b) and re-tighten

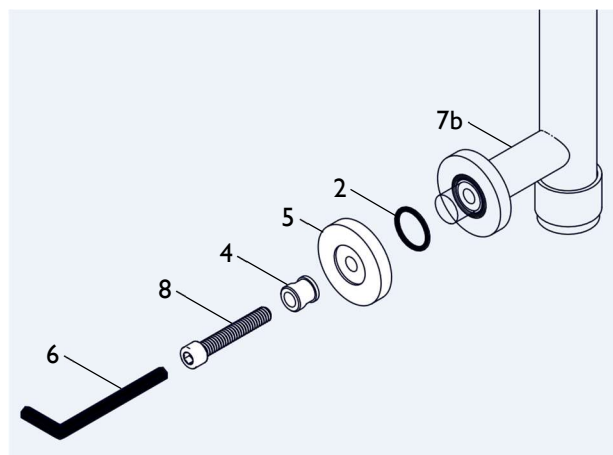

## 4

### CHECKING & ADJUSTING LEVELS

- Use level to check that BASE RINGS (5) are vertically level
- If not, loosen SCREW (8), adjust BASE RING (5) so that it is level with the other, then retighten
- Use level to check that BASE RINGS (5) are horizontally level
- If not, loosen SCREW (3), adjust BASE RING (5) so that it is level with the other, then retighten

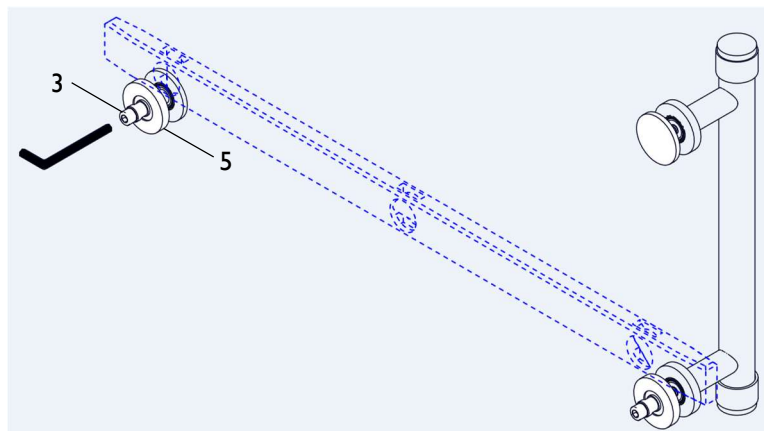
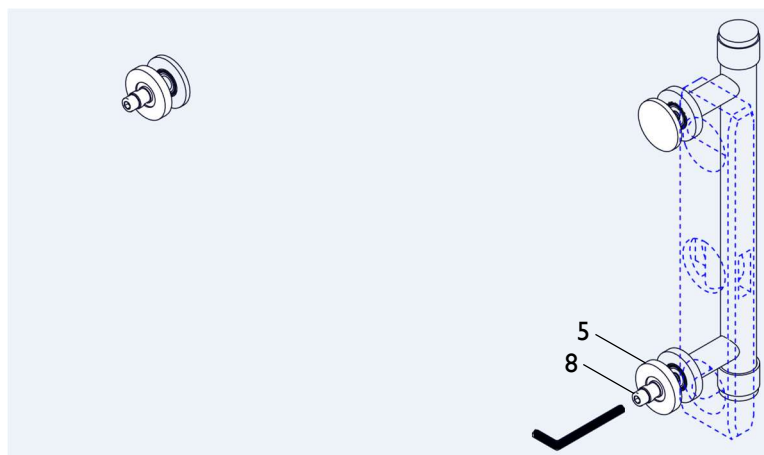

## 5

### MOUNTING OUTSIDE BAR

- Place BAR (10) onto PLUGS (4) and slide up against BASE RINGS (5)
- Fasten SETSCREWS (7c) into POSTS (10a) using HEX KEY (9)

