

 REQUIRES ITEM 

TO-THRR1-XX	TO-THQQ1-XX	TO-THQ1-XX
TO-THRR2-XX	TO-THQQ2-XX	TO-THQ2-XX
TO-THRR2S-XX	TO-THQQ2S-XX	TO-THQ2S-XX
TO-THRR3-XX	TO-THQQ3-XX	TO-THQ3-XX
TO-THRR3S-XX	TO-THQQ3S-XX	TO-THQ3S-XX

-XX	HANDLE STYLE
60	BRASS LEVER
60X	CROSS HANDLE
60X-MIDX	CROSS HANDLE, MIDX
60-ADC	BRASS LEVER, BLACK
60-RD	BRASS LEVER, RED
60-WP	PORCELAIN LEVER WHITE
60-BP	PORCELAIN LEVER BLUE
60-GP	PORCELAIN LEVER GREEN
60-OP	PORCELAIN LEVER ORANGE
60-PP	PORCELAIN LEVER PINK
60-YP	PORCELAIN LEVER YELLOW

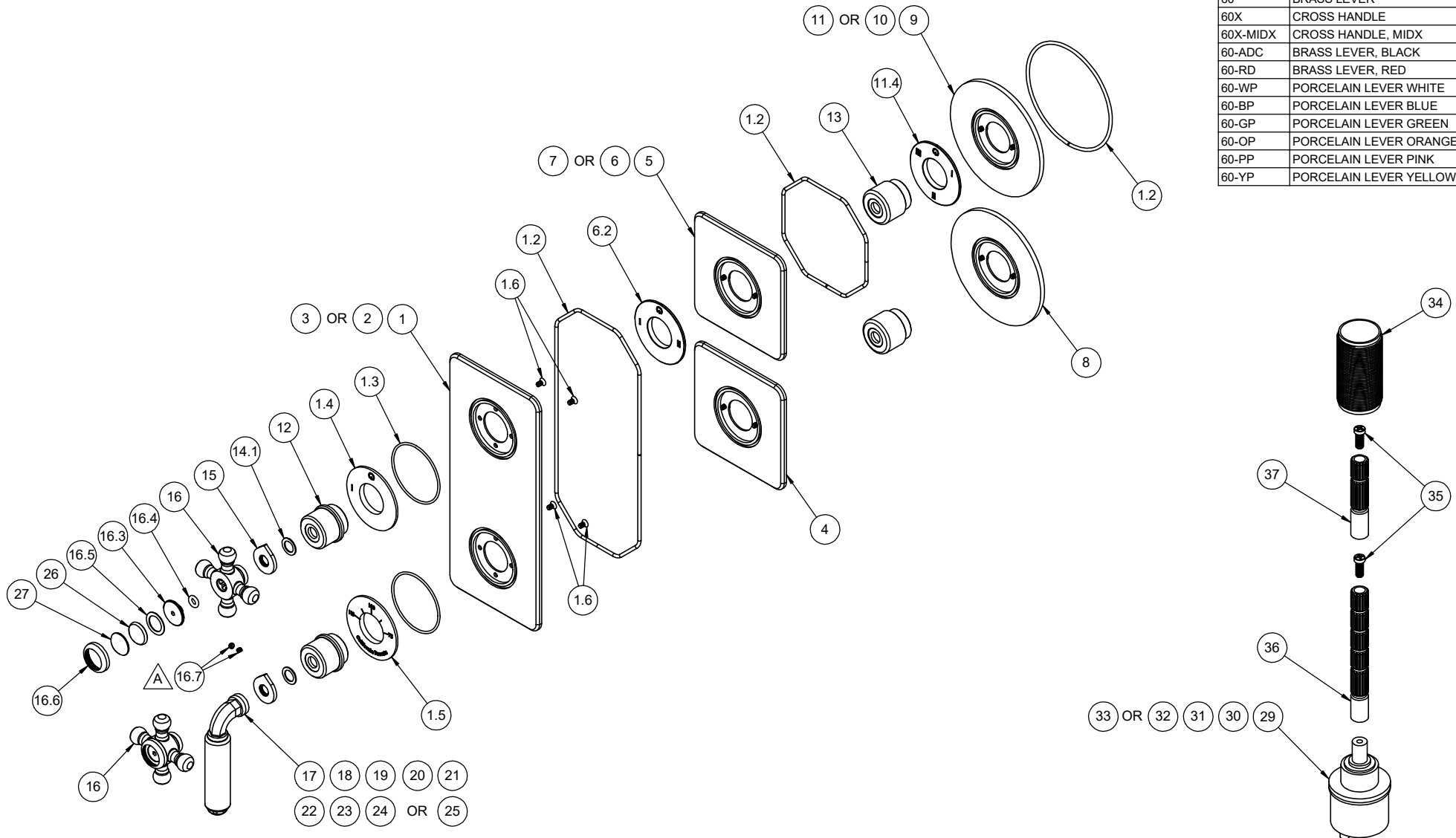

TO-THRR1-XX TO-THQQ1-XX TO-THQ1-XX
 TO-THRR2-XX TO-THQQ2-XX TO-THQ2-XX
 TO-THRR2S-XX TO-THQQ2S-XX TO-THQ2S-XX
 TO-THRR3-XX TO-THQQ3-XX TO-THQ3-XX
 TO-THRR3S-XX TO-THQQ3S-XX TO-THQ3S-XX

To order spare parts add and/or replace as stated below:

SPD- prefix added to part number(s)
-ZZ replaced with finish code (see finish table)
-WW replaced with **-90** (light finish) or **-96** (dark finish)

Ex: **SPD-7-100463-PC** or **SPD-86030-96**

-XX	HANDLE STYLE
60	BRASS LEVER
60X	CROSS HANDLE
60X-MIDX	CROSS HANDLE, MIDX
60-ADC	BRASS LEVER, BLACK
60-RD	BRASS LEVER, RED
60-WP	PORCELAIN LEVER WHITE
60-BP	PORCELAIN LEVER BLUE
60-GP	PORCELAIN LEVER GREEN
60-OP	PORCELAIN LEVER ORANGE
60-PP	PORCELAIN LEVER PINK
60-YP	PORCELAIN LEVER YELLOW

	ITEM	PART NO.	DESCRIPTION	QTY
	16.4	87154-80	O-RING Ø5.23 X 2.62 (-107) BUNA-N A70	1
	16.5	87136-80	WSHR Ø14.00 X Ø20.50 X 0.60MM	1
	16.6	10575-ZZ	BEZEL, MULTI HANDLE	1
	16.7	86030-WW	SETSCREW 8-32 X 1/8 SCKT HD CUP PT SS	2
for 60 Series	17	7-100676-ZZ	ASM, TRAD HEX LVR HDL <i>(incl. 16.7)</i>	1
for ADC Series	18	7-100676-ADC-ZZ	ASM, TRAD HEX LVR HDL, ADC <i>(incl. 16.7)</i>	1
for RD Series	19	7-100676-RD-ZZ	ASM, TRAD HEX LVR HDL, RED <i>(incl. 16.7)</i>	1
for WP Series	20	7-100677-WP-ZZ	ASM, TRAD HEX LVR HDL W/ PORC INSERT, WHITE <i>(incl. 16.7)</i>	1
for BP Series	21	7-100677-BP-ZZ	ASM, TRAD HEX LVR HDL W/ PORC INSERT, BLUE <i>(incl. 16.7)</i>	1
for GP Series	22	7-100677-GP-ZZ	ASM, TRAD HEX LVR HDL W/ PORC INSERT, GREEN <i>(incl. 16.7)</i>	1
for OP Series	23	7-100677-OP-ZZ	ASM, TRAD HEX LVR HDL W/ PORC INSERT, ORANGE <i>(incl. 16.7)</i>	1
for PP Series	24	7-100677-PP-ZZ	ASM, TRAD HEX LVR HDL W/ PORC INSERT, PINK <i>(incl. 16.7)</i>	1
for YP Series	25	7-100677-YP-ZZ	ASM, TRAD HEX LVR HDL W/ PORC INSERT, YELLOW <i>(incl. 16.7)</i>	1
for 60X Series	26	471071-40	BUTTON, INDEX, 47, BLANK, PORC (Ø20 X 5.5MM)	1
for 60X-MIDX	27	471168-ZZ	BUTTON, INDEX, METAL	1
for ITEM 16.7	28	882042-99	KEY, ALLEN, 5/64", BLACK	1
for TO-THX1	29	880639-99	CART, Ø33 1 OUTLET DIVERTER	1
for TO-THX2	30	880640-99	CART, Ø33 2 OUTLET DIVERTER	1
for TO-THX3	31	880641-99	CART, Ø33 3 OUTLET DIVERTER	1
for TO-THX2S	32	880657-99	CART, Ø33 2 OUTLET DIVERTER - SHARED	1
for TO-THX3S	33	880658-99	CART, Ø33 3 OUTLET DIVERTER - SHARED	1
	34	11527-ZZ	ALL THREAD, THERM 2.0 TRIM	1
	35	86078-90	SCREW, M4 X 0.7 X 10MM, w/Ø5.80 PHL PH HD SS	2
	36	880137-98	BROACH EXTENSION 3-1/4"(L) X 16T(M) X 20T(F)	1
	37	880663-98	BROACH EXTENSION 2"(L) X 16T(M) X 20T(F)	1

	ITEM	PART NO.	DESCRIPTION	QTY
for TO-THQ1	1	7-100751-ZZ	ASM, THERM 2.0 QUAD PLATE, 1 OUTLET <i>(incl. 1.2, 1.3, 1.4, 1.5, 1.6)</i>	1
	1.2	87127-80	O-RING CORD 2.62 (.103") SOFT BUNA-N A50 <i>(Order quantity will be 23")</i>	1
	1.3	881487-99	O-RING Ø50.52 X 1.78 (-033) BUNA-N A70	2
	1.4	11519-ZZ	NOMENCLATURE, 2 HANDLE THERM, 1-WAY DIVERTER	1
	1.5	11522-ZZ	NOMENCLATURE, 2 HANDLE THERM, TEMP	1
	1.6	86171-90	SCREW 6-32 X 1/4" PH FLT HD SS	4
for TO-THQ2 & TO-THQ2S	2	7-100752-ZZ	ASM, THERM 2.0 QUAD PLATE, 2 OUTLET <i>(incl. 1.2, 1.3, 1.5, 1.6, 6.2)</i>	1
for TO-THQ3 & TO-THQ3S	3	7-100753-ZZ	ASM, THERM 2.0 QUAD PLATE, 3 OUTLET <i>(incl. 1.2, 1.3, 1.5, 1.6, 11.4)</i>	1
for all TO-THQQ	4	7-100773-ZZ	ASM, THERM 2.0 INDIV QUAD PLATE, TEMP <i>(incl. 1.2, 1.3, 1.5, 1.6)</i>	1
for TO-THQQ1	5	7-100761-ZZ	ASM, THERM 2.0 INDIV QUAD PLATE, 1 OUTLET <i>(incl. 1.2, 1.3, 1.4, 1.6)</i>	1
for TO-THQQ2 & TO-THQQ2S	6	7-100762-ZZ	ASM, THERM 2.0 INDIV QUAD PLATE, 2 OUTLET <i>(incl. 1.2, 1.3, 1.6, 6.2)</i>	1
	6.2	11520-ZZ	NOMENCLATURE, 2 HANDLE THERM, 2-WAY DIVERTER	1
for TO-THQQ3 & TO-THQQ3S	7	7-100763-ZZ	ASM, THERM 2.0 INDIV QUAD PLATE, 3 OUTLET <i>(incl. 1.2, 1.3, 1.6, 11.4)</i>	1
for all TO-THRR	8	7-100774-ZZ	ASM, THERM 2.0 INDIV ROUND PLATE, TEMP <i>(incl. 1.2, 1.3, 1.5, 1.6)</i>	1
for TO-THRR1	9	7-100766-ZZ	ASM, THERM 2.0 INDIV ROUND PLATE, 1 OUTLET <i>(incl. 1.2, 1.3, 1.4, 1.6)</i>	1
for TO-THRR2 & TO-THRR2S	10	7-100767-ZZ	ASM, THERM 2.0 INDIV ROUND PLATE, 2 OUTLET <i>(incl. 1.2, 1.3, 1.6, 6.2)</i>	1
for TO-THRR3 & TO-THRR3S	11	7-100768-ZZ	ASM, THERM 2.0 INDIV ROUND PLATE, 3 OUTLET <i>(incl. 1.2, 1.3, 1.6, 11.4)</i>	1
	11.4	11521-ZZ	NOMENCLATURE, 2 HANDLE THERM, 3-WAY DIVERTER	1
for all TO-THQ & TO-THQQ	12	11518-ZZ	ESCUTCHEON, 2 HANDLE THERM, TRANS	2
for all TO-THRR	13	11517-ZZ	ESCUTCHEON, 2 HANDLE THERM, CONT	2
	14.1	87340-81	WSHR Ø.590" X Ø.390" X .030" BLK UHMW	2
	15	11523-ZZ	INDICATOR, 2 HANDLE THERM, DIAL	2
for 60X Series	16	7-100534-ZZ	ASM, CROSS HANDLE, TRADS <i>(incl. 16.3, 16.4, 16.5, 16.6, 16.7)</i>	1
	16.3	10610-15B	INSERT, THD, BEZEL HDL	1