

 REQUIRES ITEM 

TO-THRR1-XX	TO-THQQ1-XX	TO-THQ1-XX
TO-THRR2-XX	TO-THQQ2-XX	TO-THQ2-XX
TO-THRR2S-XX	TO-THQQ2S-XX	TO-THQ2S-XX
TO-THRR3-XX	TO-THQQ3-XX	TO-THQ3-XX
TO-THRR3S-XX	TO-THQQ3S-XX	TO-THQ3S-XX

-XX	HANDLE STYLE
30	SMOOTH LEVER
30F	CARBON FIBER LEVER
30K	KNURLED LEVER
30T	TEAK LEVER
30X	CROSS HANDLE
30XF	CARBON FIBER CROSS HANDLE
30XK	KNURLED CROSS HANDLE
30XT	TEAK CROSS HANDLE

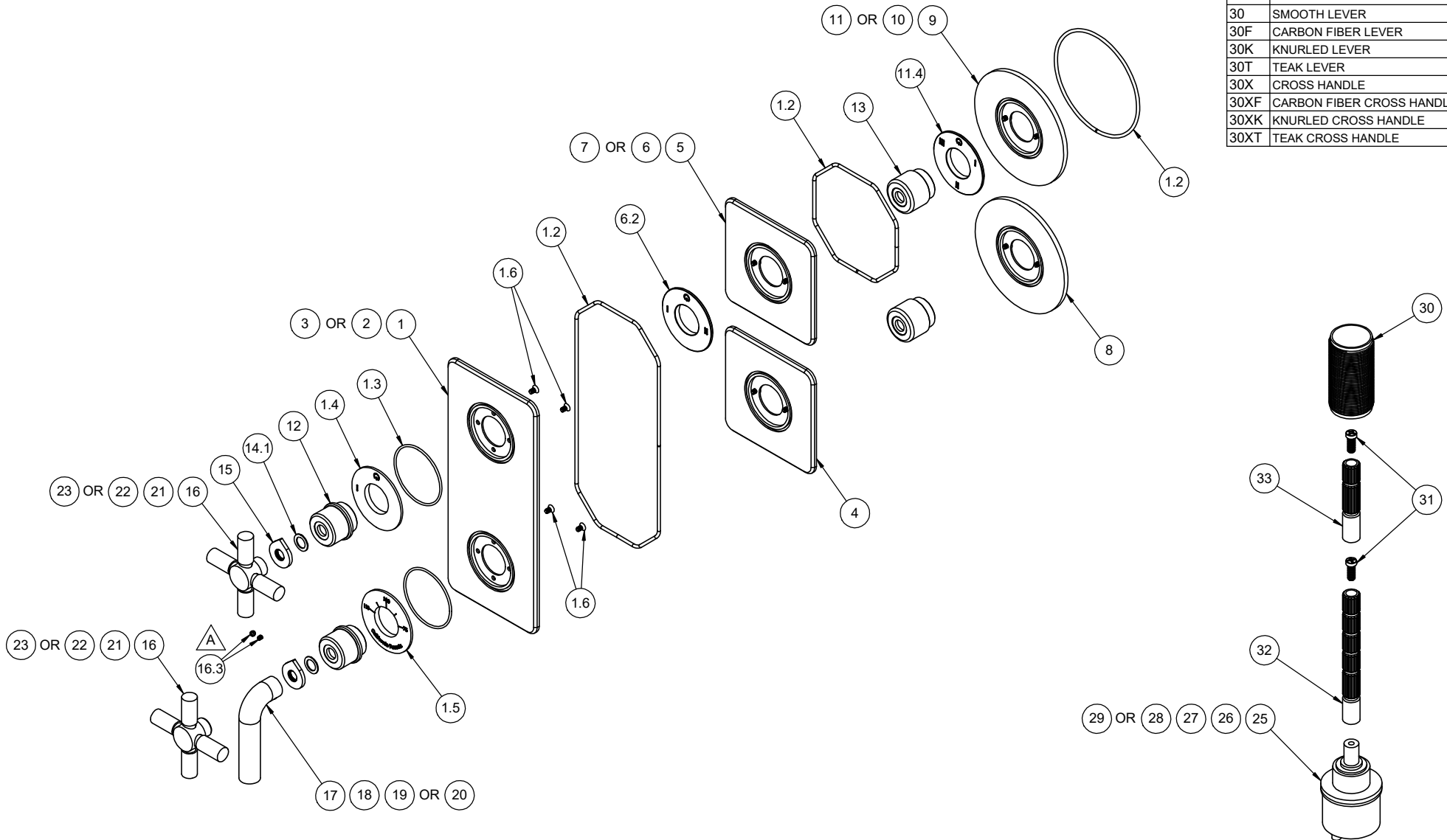

-XX	HANDLE STYLE
30	SMOOTH LEVER
30F	CARBON FIBER LEVER
30K	KNURLED LEVER
30T	TEAK LEVER
30X	CROSS HANDLE
30XF	CARBON FIBER CROSS HANDLE
30XK	KNURLED CROSS HANDLE
30XT	TEAK CROSS HANDLE

TO-THRR1-XX TO-THQQ1-XX TO-THQ1-XX  
 TO-THRR2-XX TO-THQQ2-XX TO-THQ2-XX  
 TO-THRR2S-XX TO-THQQ2S-XX TO-THQ2S-XX  
 TO-THRR3-XX TO-THQQ3-XX TO-THQ3-XX  
 TO-THRR3S-XX TO-THQQ3S-XX TO-THQ3S-XX

To order spare parts add and/or replace as stated below:

**SPD**- prefix added to part number(s)  
**-ZZ** replaced with finish code (see finish table)  
**-WW** replaced with **-90** (light finish) or **-96** (dark finish)

Ex: **SPD-7-100463-PC** or **SPD-86030-96**

	ITEM	PART NO.	DESCRIPTION	QTY
for 30X Series	16	7-100291-ZZ	ASM, INDUSTRIAL X-HDL SMOOTH <i>(incl. 16.3)</i>	1
	16.3	86030-WW	SETSCREW 8-32 X 1/8 SCKT HD CUP PT SS	2
for 30 Series	17	7-100146-ZZ	ASM, LEVER, 74 SERIES "BROACHED" <i>(incl. 16.3)</i>	1
for 30F Series	18	7-100277-ZZ	ASM, CARBON FIBER LEVER <i>(incl. 16.3)</i>	1
for 30K Series	19	7-100271-ZZ	ASM, KNURLED LEVER <i>(incl. 16.3)</i>	1
for 30T Series	20	7-100564-ZZ	ASM, INDUSTRIAL HDL TEAK <i>(incl. 16.3)</i>	1
for 30XF Series	21	7-100292-ZZ	ASM, INDUSTRIAL X-HDL CARBON FIBER <i>(incl. 16.3)</i>	1
for 30XK Series	22	7-100293-ZZ	ASM, INDUSTRIAL X-HDL KNURLED <i>(incl. 16.3)</i>	1
for 30XT Series	23	7-100565-ZZ	ASM, INDUSTRIAL X-HDL TEAK <i>(incl. 16.3)</i>	1
for ITEM 16.3	24	882042-99	KEY, ALLEN, 5/64", BLACK	1
for TO-THX1	25	880639-99	CART, Ø33 1 OUTLET DIVERter	1
for TO-THX2	26	880640-99	CART, Ø33 2 OUTLET DIVERter	1
for TO-THX3	27	880641-99	CART, Ø33 3 OUTLET DIVERter	1
for TO-THX2S	28	880657-99	CART, Ø33 2 OUTLET DIVERter - SHARED	1
for TO-THX3S	29	880658-99	CART, Ø33 3 OUTLET DIVERter - SHARED	1
	30	11527-ZZ	ALL THREAD, THERM 2.0 TRIM	1
	31	86078-90	SCREW, M4 X 0.7 X 10MM, w/Ø5.80 PHL PH HD SS	2
	32	880137-98	BROACH EXTENSION 3-1/4"(L) X 16T(M) X 20T(F)	1
	33	880663-98	BROACH EXTENSION 2"(L) X 16T(M) X 20T(F)	1

	ITEM	PART NO.	DESCRIPTION	QTY
for TO-THQ1	1	7-100751-ZZ	ASM, THERM 2.0 QUAD PLATE, 1 OUTLET <i>(incl. 1.2, 1.3, 1.4, 1.5, 1.6)</i>	1
	1.2	87127-80	O-RING CORD 2.62 (.103") SOFT BUNA-N A50 <i>(Order quantity will be 23")</i>	1
	1.3	881487-99	O-RING Ø50.52 X 1.78 (-033) BUNA-N A70	2
	1.4	11519-ZZ	NOMENCLATURE, 2 HANDLE THERM, 1-WAY DIVERter	1
	1.5	11522-ZZ	NOMENCLATURE, 2 HANDLE THERM, TEMP	1
	1.6	86171-90	SCREW 6-32 X 1/4" PH FLT HD SS	4
for TO-THQ2 & TO-THQ2S	2	7-100752-ZZ	ASM, THERM 2.0 QUAD PLATE, 2 OUTLET <i>(incl. 1.2, 1.3, 1.5, 1.6, 6.2)</i>	1
for TO-THQ3 & TO-THQ3S	3	7-100753-ZZ	ASM, THERM 2.0 QUAD PLATE, 3 OUTLET <i>(incl. 1.2, 1.3, 1.5, 1.6, 11.4)</i>	1
for all TO-THQQ	4	7-100773-ZZ	ASM, THERM 2.0 INDIV QUAD PLATE, TEMP <i>(incl. 1.2, 1.3, 1.5, 1.6)</i>	1
for TO-THQQ1	5	7-100761-ZZ	ASM, THERM 2.0 INDIV QUAD PLATE, 1 OUTLET <i>(incl. 1.2, 1.3, 1.4, 1.6)</i>	1
for TO-THQQ2 & TO-THQQ2S	6	7-100762-ZZ	ASM, THERM 2.0 INDIV QUAD PLATE, 2 OUTLET <i>(incl. 1.2, 1.3, 1.6, 6.2)</i>	1
	6.2	11520-ZZ	NOMENCLATURE, 2 HANDLE THERM, 2-WAY DIVERter	1
for TO-THQQ3 & TO-THQQ3S	7	7-100763-ZZ	ASM, THERM 2.0 INDIV QUAD PLATE, 3 OUTLET <i>(incl. 1.2, 1.3, 1.6, 11.4)</i>	1
for all TO-THRR	8	7-100774-ZZ	ASM, THERM 2.0 INDIV ROUND PLATE, TEMP <i>(incl. 1.2, 1.3, 1.5, 1.6)</i>	1
for TO-THRR1	9	7-100766-ZZ	ASM, THERM 2.0 INDIV ROUND PLATE, 1 OUTLET <i>(incl. 1.2, 1.3, 1.4, 1.6)</i>	1
for TO-THRR2 & TO-THRR2S	10	7-100767-ZZ	ASM, THERM 2.0 INDIV ROUND PLATE, 2 OUTLET <i>(incl. 1.2, 1.3, 1.6, 6.2)</i>	1
for TO-THRR3 & TO-THRR3S	11	7-100768-ZZ	ASM, THERM 2.0 INDIV ROUND PLATE, 3 OUTLET <i>(incl. 1.2, 1.3, 1.6, 11.4)</i>	1
	11.4	11521-ZZ	NOMENCLATURE, 2 HANDLE THERM, 3-WAY DIVERter	1
for all TO-THQ & TO-THQQ	12	11518-ZZ	ESCUTCHEON, 2 HANDLE THERM, TRANS	2
for all TO-THRR	13	11517-ZZ	ESCUTCHEON, 2 HANDLE THERM, CONT	2
	14.1	87340-81	WSHR Ø.590" X Ø.390" X .030" BLK UHMW	2
	15	11523-ZZ	INDICATOR, 2 HANDLE THERM, DIAL	2