

- △ REQUIRES ITEM 17
- △ REQUIRES ITEM 8.6
- △ REQUIRES ITEM 16
- △ REQUIRES ITEM 8.7.6

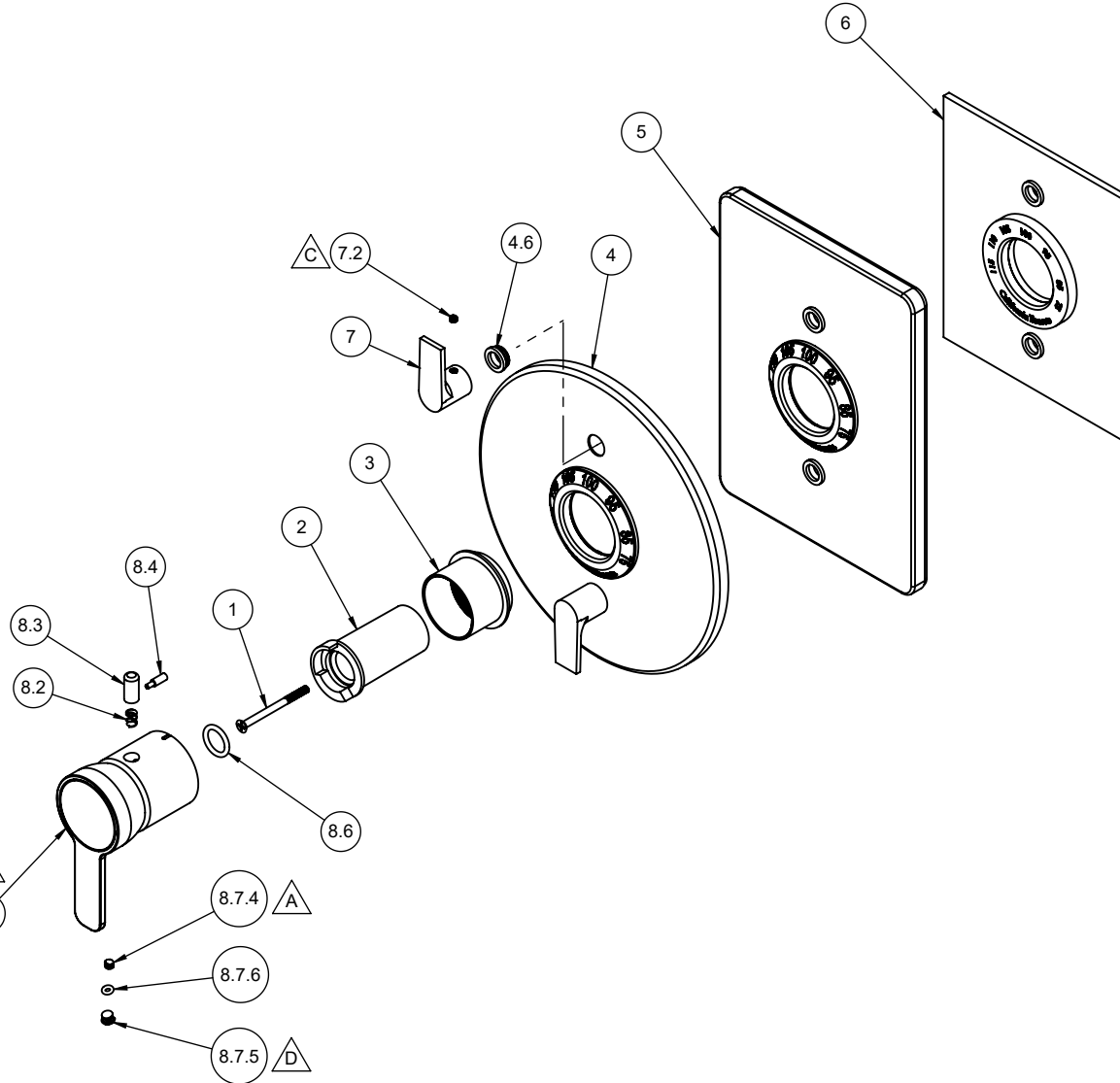

- △ B △ B △ B △ B △ B
- 12 11 10 9 8
- 13 14 OR 15
- △ B △ B △ B

- TO-TH2L-87
- TO-TH2L-87-BG
- TO-TH2L-87-BKS
- TO-TH2L-87-WS
- TO-TH2L-87-RS
- TO-TH2L-87-GS
- TO-TH2L-87-BS
- TO-TH2L-87-TES
- TO-THC2L-87
- TO-THC2L-87-BG
- TO-THC2L-87-BKS
- TO-THC2L-87-WS
- TO-THC2L-87-RS
- TO-THC2L-87-GS
- TO-THC2L-87-BS
- TO-THC2L-87-TES
- TO-THF2L-87
- TO-THF2L-87-BG
- TO-THF2L-87-BKS
- TO-THF2L-87-WS
- TO-THF2L-87-RS
- TO-THF2L-87-GS
- TO-THF2L-87-BS
- TO-THF2L-87-TES

TO-THF2L-87	TO-THC2L-87	TO-TH2L-87
TO-THF2L-87-BG	TO-THC2L-87-BG	TO-TH2L-87-BG
TO-THF2L-87-BKS	TO-THC2L-87-BKS	TO-TH2L-87-BKS
TO-THF2L-87-WS	TO-THC2L-87-WS	TO-TH2L-87-WS
TO-THF2L-87-RS	TO-THC2L-87-RS	TO-TH2L-87-RS
TO-THF2L-87-GS	TO-THC2L-87-GS	TO-TH2L-87-GS
TO-THF2L-87-BS	TO-THC2L-87-BS	TO-TH2L-87-BS
TO-THF2L-87-TES	TO-THC2L-87-TES	TO-TH2L-87-TES

To order spare parts add and/or replace as stated below:

**SPD**- prefix added to part number(s)

**-ZZ** replaced with finish code (see finish table)

**-WW** replaced with **-90** (light finish) or **-96** (dark finish)

Ex: **SPD-7-100463-PC** or **SPD-86030-96**

	ITEM	PART NO.	DESCRIPTION	QTY
for 87-RS Series	12	TH-H-87-RS-ZZ	THERM HANDLE KIT <i>(incl. 8.2, 8.3, 8.4, 8.6, 8.7.4, 8.7.5, 8.7.6)</i>	1
for 87-GS Series	13	TH-H-87-GS-ZZ	THERM HANDLE KIT <i>(incl. 8.2, 8.3, 8.4, 8.6, 8.7.4, 8.7.5, 8.7.6)</i>	1
for 87-BS Series	14	TH-H-87-BS-ZZ	THERM HANDLE KIT <i>(incl. 8.2, 8.3, 8.4, 8.6, 8.7.4, 8.7.5, 8.7.6)</i>	1
for 87-TES Series	15	TH-H-87-TES-ZZ	THERM HANDLE KIT <i>(incl. 8.2, 8.3, 8.4, 8.6, 8.7.4, 8.7.5, 8.7.6)</i>	1
for ITEM 7.2	16	882042-99	KEY, ALLEN, 5/64", BLACK	1
for ITEM 8.7.4	17	882043-99	KEY, ALLEN, 3/32", BLACK	1

	ITEM	PART NO.	DESCRIPTION	QTY
	1	86059-90	SCREW M4 X 0.7 X 60MM PH FLT HD SS	1
	2	10092-81	STOP, THERM TEMP, SHORT	1
	3	10090-ZZ	SLEEVE, THERMO MOUNTING	1
for TO-TH2L	4	7-100042-ZZ	ASM, SHWRPLATE, CONT RD, THERM W/2VC <i>(incl. 4.6)</i>	1
	4.6	223467-99	NYLON BUSHING FOR PBS FACEPLATE	2
for TO-THC2L	5	7-100048-ZZ	ASM, SHOWERPLATE, CONT SQ. THERM W/ 2 VC <i>(incl. 4.6)</i>	1
for TO-THF2L	6	7-100240-ZZ	ASM, SHWRPLATE, CONT FLAT, THERM W/2 VC <i>(incl. 4.6)</i>	1
	7	7-100179-ZZ	ASM, THERM VC - TRANS <i>(incl. 7.2)</i>	2
	7.2	86030-WW	SETSCREW 8-32 X 1/8 SCKT HD CUP PT SS	1
for 87 Series	8	TH-H-87-ZZ	THERM HANDLE KIT <i>(incl. 8.2, 8.3, 8.4, 8.6, 8.7.4, 8.7.5, 8.7.6)</i>	1
	8.2	10098-90	SPRING, Ø.24 X .312 LG, 1.4 LB/IN	1
	8.3	10093-81	BUTTON, BLACK THERM	1
	8.4	10062-98	PIN, THERMO BONNET	1
	8.6	87222-80	O-RING Ø13.94 X 2.62 (-113) EPDM A70 (NSF61-12 & WRAS)	1
	8.7.4	86047-90	SETSCREW 10-24 X 3/16 SCKT HD CONE PT SS	1
	8.7.5	10444-ZZ	CAP, HANDLE SCRW	1
	8.7.6	87321-80	O-RING Ø2.80 X 1.90 (NA) BUNA-N A70	1
for 87-BG Series	9	TH-H-87-BG-ZZ	THERM HANDLE KIT <i>(incl. 8.2, 8.3, 8.4, 8.6, 8.7.4, 8.7.5, 8.7.6)</i>	1
for 87-BKS Series	10	TH-H-87-BKS-ZZ	THERM HANDLE KIT <i>(incl. 8.2, 8.3, 8.4, 8.6, 8.7.4, 8.7.5, 8.7.6)</i>	1
for 87-WS Series	11	TH-H-87-WS-ZZ	THERM HANDLE KIT <i>(incl. 8.2, 8.3, 8.4, 8.6, 8.7.4, 8.7.5, 8.7.6)</i>	1