

TO-PBL-C1  
TO-PBL-C1X  
TO-PBL-C1XS  
TO-PB2L-C1  
TO-PB2L-C1X  
TO-PB2L-C1XS

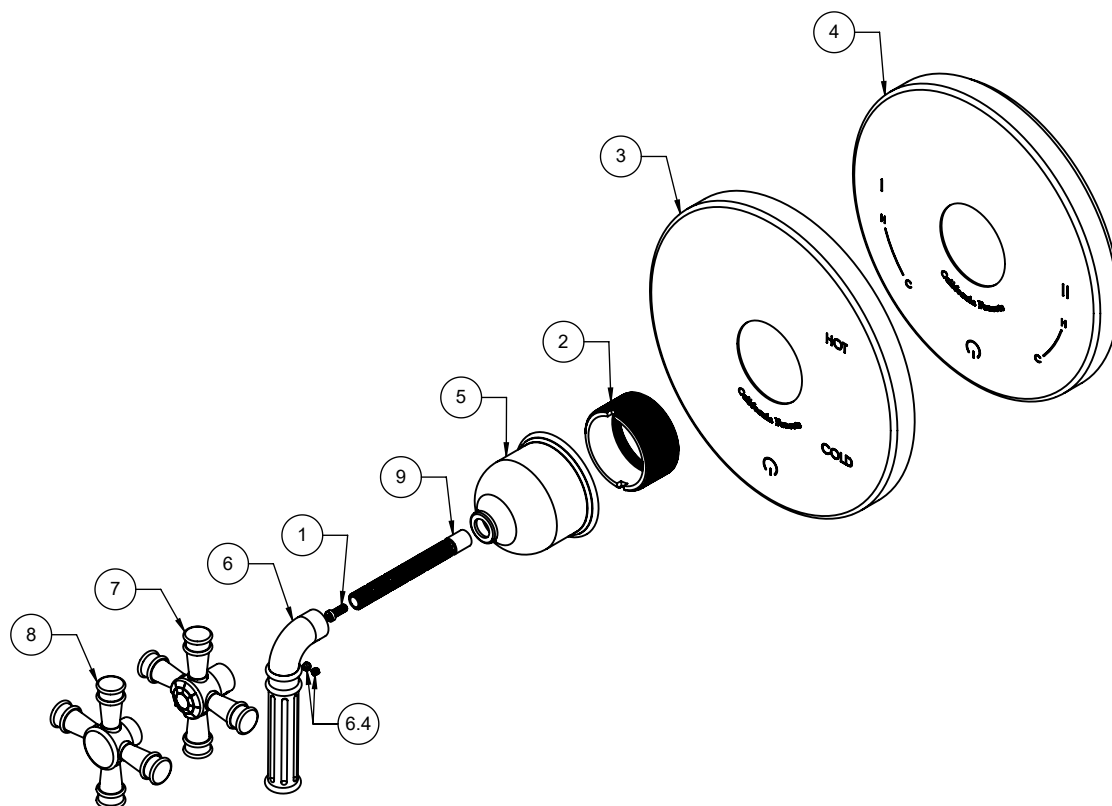

To order spare parts add and/or replace as stated below:

**SPD-** prefix added to part number(s)  
**-ZZ** replaced with finish code (see finish table)  
**-WW** replaced with **-90** (light finish) or **-96** (dark finish)

Ex: **SPD-7-100362-PC** or **SPD-86030-96**

ITEM	PART NO.	DESCRIPTION	QTY.
1	86078-90	SCREW, M4 X 0.7 X 10MM, w/Ø5.80 PHL PH HD SS	1
2	10292-98	BUSHING, PB G2	1
for TO-PBL 3	7-100106-ZZ	ASM, CONT PB PLATE & GASKET	1
for TO-PB2L 4	7-100547-ZZ	ASM, CONT PB2 PLATE & GASKET	1
5	10293-ZZ	ESCUTCHEON, TRAD, PB G2	1
for C1 series 6	7-100417-ZZ	ASM, C1 BROACHED LEVER (incl. 6.4)	1
6.4	86030-WW	SETSCREW 8-32 X 1/8 SCKT HD CUP PT SS	2
for C1X series 7	7-100419-ZZ	ASM, C1 BROACHED X-HDL (incl. 6.4)	1
for C1XS series 8	7-100538-ZZ	ASM, C1 BROACHED SMOOTH X-HDL (incl. 6.4)	1
9	880137-98	BROACH EXTENSION 3-1/4"(L) X 16T(M) X 20T(F)	1
for ITEM 6.4 10	882042-99	KEY, ALLEN, 5/64", BLACK	1