

△ REQUIRES ITEM 3, 4, AND 5

TO-V6502-7
TO-V6602-7
TO-V6502-9
TO-V6602-9

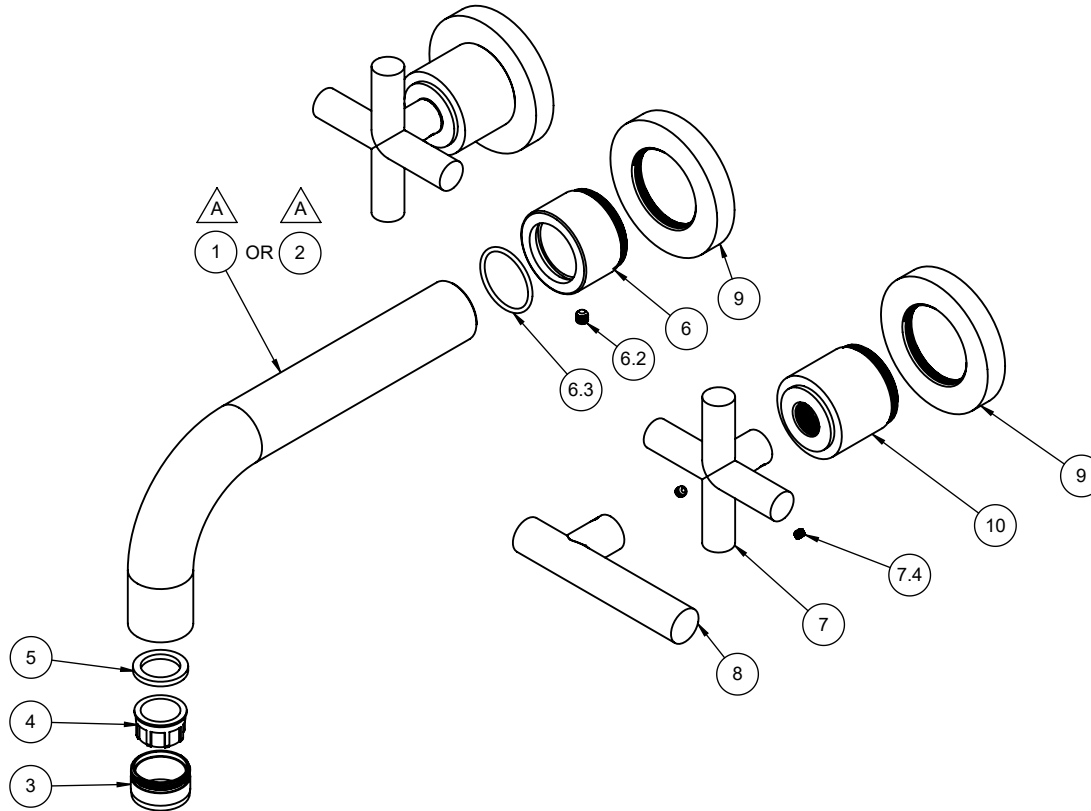

To order spare parts add and/or replace as stated below:

SPD- prefix added to part number(s)
-ZZ replaced with finish code (see finish table)
-WW replaced with **-90** (light finish) or **-96** (dark finish)

Ex: **SPD-7-100463-PC** or **SPD-86030-96**

	ITEM	PART NO.	DESCRIPTION	QTY
for all -7	1	7-100085-ZZ	ASM, VS SPOUT, 7" CONT TUBE STYLE, "NL"	1
for all -9	2	7-100086-ZZ	ASM, VS SPOUT, 9" CONT TUBE STYLE, "NL"	1
	3	880168-ZZ	SHELL, STD 15/16"-27, MALE THD	1
	4	880354-81	INSERT, 1.2 GPM STD AERATED (PCA PERLATOR)	1
	5	881829-99	WSHR AERATOR, .839 X .590 X .110 EPDM A70 (NSF 61)	1
	6	7-653092-ZZ	BASE W/ SETSCREW & O-RING <i>(incl. 6.2, 6.3)</i>	1
	6.2	86033-WW	SETSCREW 10-24 X 3/16 SCKT HD CUP PT SS	1
	6.3	87204-80	O-RING Ø25.12 X 1.78 (-022) EPDM A70 (NSF-61 & WRAS)	1
for 65 Series	7	7-653143-ZZ	KIT, CTEMP CROSS HDL, 65 SERIES <i>(incl. 7.4)</i>	2
	7.4	86030-WW	SETSCREW 8-32 X 1/8 SCKT HD CUP PT SS	2
for 66 Series	8	7-663144-ZZ	KIT, CTEMP LEV HDL, 66 SERIES <i>(incl. 7.4)</i>	2
	9	652119-ZZ	RING, ESC/LAV/RT, 65 & 66 SERIES, SMOOTH	3
	10	652120-ZZ	ESCUTCHEON, 65 & 66 SERIES	2
for ITEM 6.2	11	882043-99	KEY, ALLEN, 3/32", BLACK	1
for ITEM 7.4	12	882042-99	KEY, ALLEN, 5/64", BLACK	1