

 REQUIRES ITEM 

TO-C1-W  
TO-C1X-W  
TO-C1XS-W  
TO-C106L  
TO-C106XL  
TO-C106XSL  
TO-C103L  
TO-C103XL  
TO-C103XSL

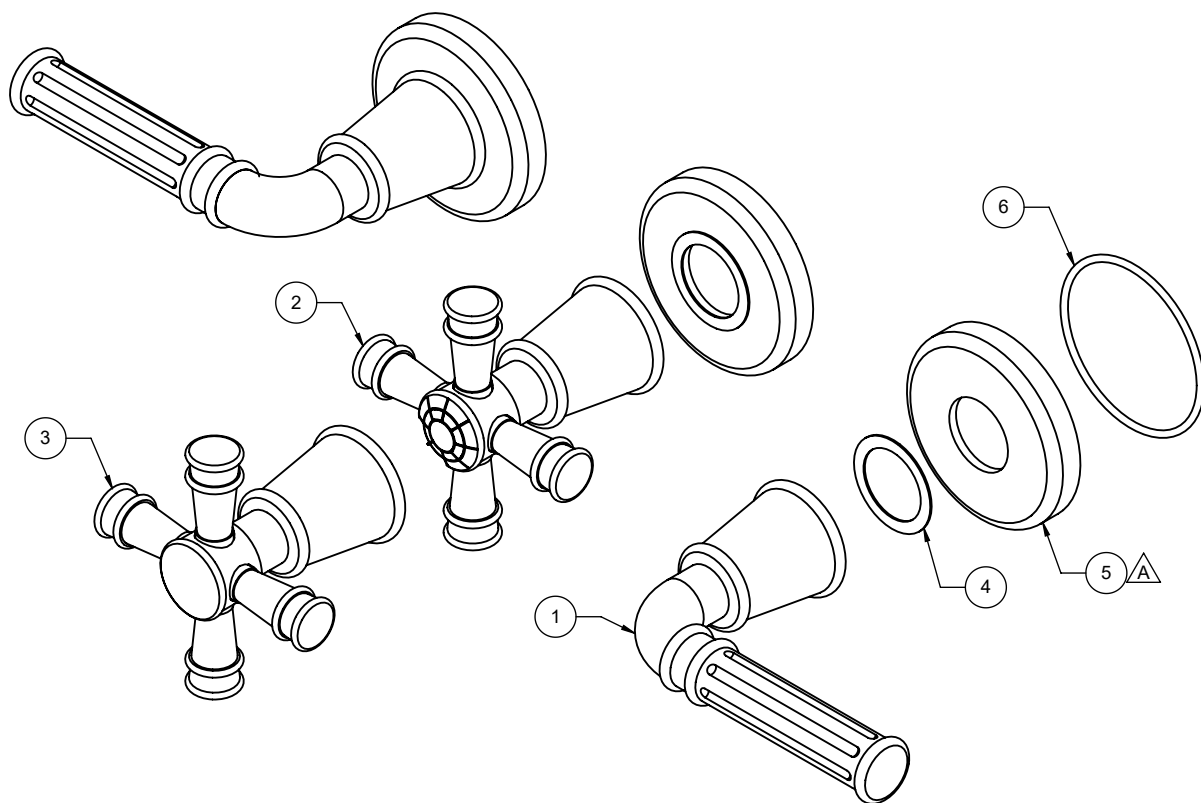

To order spare parts add and/or replace as stated below:

**SPD-** prefix added to part number(s)

**-ZZ** replaced with finish code (see finish table)

**-WW** replaced with **-90** (light finish) or **-96** (dark finish)

Ex: **SPD-7-100362-PC** or **SPD-86030-96**

	ITEM	PART NO.	DESCRIPTION	QTY.
for C1 series	1	7-100416-ZZ	ASM, C1 THREADED LEVER HDL	2
for C1X series	2	7-100418-ZZ	ASM, C1 THREADED X-HDL	3
for C1XS series	3	7-100537-ZZ	ASM, C1 THREADED X-HDL - SMOOTH	3
	4	87191-81	WSHR Ø21.46 X Ø28.58 X 0.508MM UHMW	3
	5	10990-ZZ	RING, Ø22.0MM ID BASE, R3.0MM	3
	6	87263-80	O-RING Ø49.00 X 2.00 (NA) BUNA-N A70	3