

- △ REQUIRES ITEM (2)
- △ REQUIRES ITEM (29)
- △ REQUIRES ITEM (9.6)
- △ REQUIRES ITEM (30)
- △ REQUIRES ITEM (18.4)

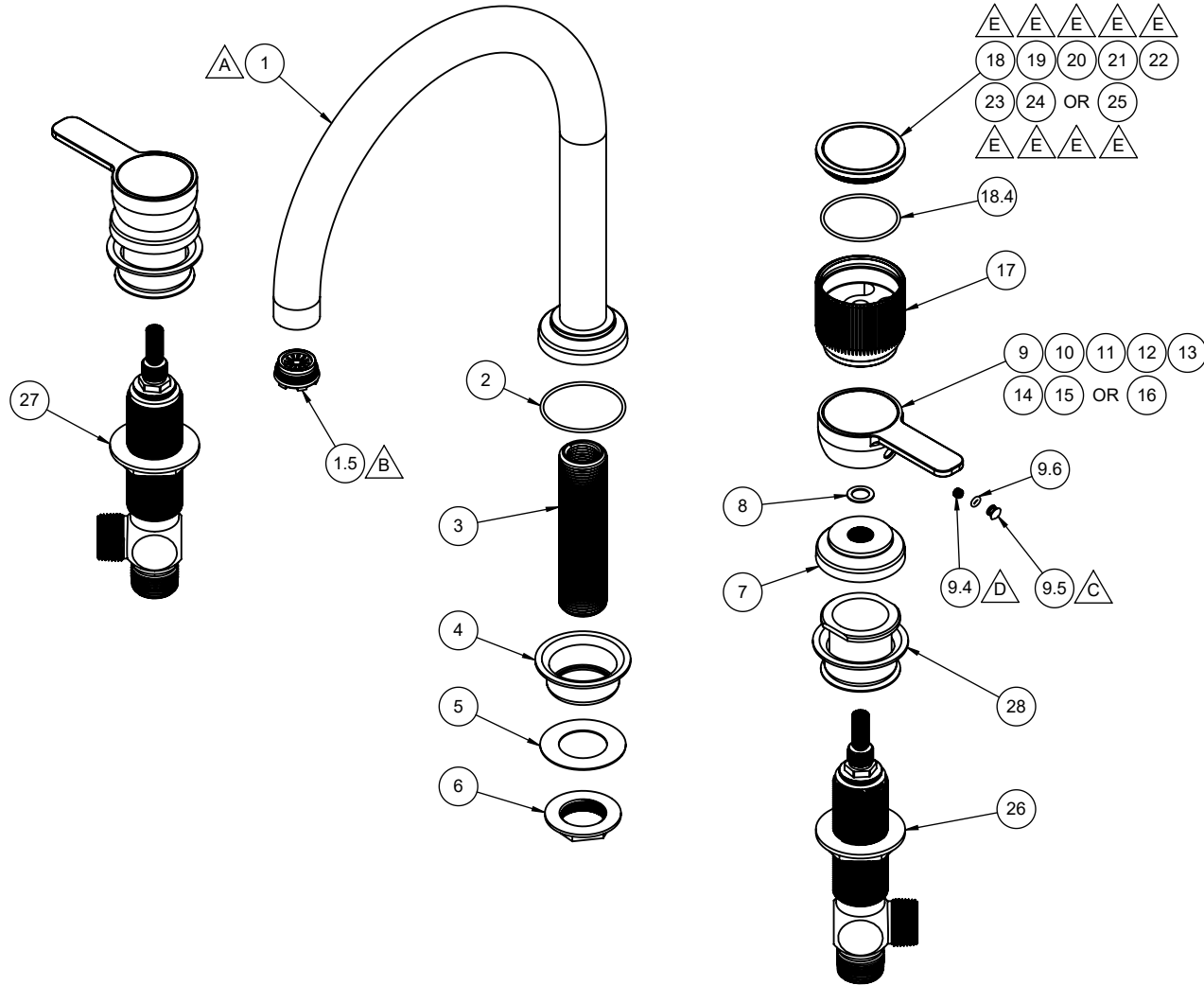

- 8708A
- 8708A-BG
- 8708A-BKS
- 8708A-WS
- 8708A-RS
- 8708A-GS
- 8708A-BS
- 8708A-TES
- 8708AP
- 8708AP-BG
- 8708AP-BKS
- 8708AP-WS
- 8708AP-RS
- 8708AP-GS
- 8708AP-BS
- 8708AP-TES

8708AP	8708A
8708AP-BG	8708A-BG
8708AP-BKS	8708A-BKS
8708AP-WS	8708A-WS
8708AP-RS	8708A-RS
8708AP-GS	8708A-GS
8708AP-BS	8708A-BS
8708AP-TES	8708A-TES

To order spare parts add and/or replace as stated below:

SPD- prefix added to part number(s)
-ZZ replaced with finish code (see finish table)
-WW replaced with **-90** (light finish) or **-96** (dark finish)

Ex: **SPD-7-100463-PC** or **SPD-86030-96**

	ITEM	PART NO.	DESCRIPTION	QTY
for all 8708AP Series	17	7-100726-ZZ	ASM, HANDLE, ART DECO CYLINDER <i>(incl. 9.4, 9.5, 9.6)</i>	1
for 8708AP Series	18	7-100775-ZZ	ASM, ART DECO CYL HDL CAP <i>(incl. 19.4)</i>	1
for ITEMS 18 to 25	18.4	87175-80	O-RING Ø41.00 X 1.78 (-030) BUNA-N A70	1
for 8708AP-BG Series	19	7-100775-BG-ZZ	ASM, ART DECO CYL HDL CAP, BLACK GLASS <i>(incl. 19.4)</i>	2
for 8708AP-BKS Series	20	7-100775-BKS-ZZ	ASM, ART DECO CYL HDL CAP, BLACK MARBLE <i>(incl. 19.4)</i>	2
for 8708AP-WS Series	21	7-100775-WS-ZZ	ASM, ART DECO CYL HDL CAP, WHITE MARBLE <i>(incl. 19.4)</i>	2
for 8708AP-RS Series	22	7-100775-RS-ZZ	ASM, ART DECO CYL HDL CAP, RED JASPER <i>(incl. 19.4)</i>	2
for 8708AP-GS Series	23	7-100775-GS-ZZ	ASM, ART DECO CYL HDL CAP, GREEN AVENTURINE <i>(incl. 19.4)</i>	2
for 8708AP-BS Series	24	7-100775-BS-ZZ	ASM, ART DECO CYL HDL CAP, BLUE SODALITE <i>(incl. 19.4)</i>	2
for 8708AP-TES Series	25	7-100775-TES-ZZ	ASM, ART DECO CYL HDL CAP, TIGER EYE <i>(incl. 19.4)</i>	2
	26	6-200081	ASM, COLD-RT BODY, CART & NUT (LTC)	1
	27	6-200082	ASM, HOT-RT BODY, CART & NUT (RTC)	1
	28	6-200297	KIT, RT INV NUT - 2 SETS (1 SET - 6-200297-1)	1
for ITEM 1.5	29	223473-99	KEY, STD CACHE AERATOR INSERT	1
for ITEM 9.4	30	882043-99	KEY, ALLEN, 3/32", BLACK	1

	ITEM	PART NO.	DESCRIPTION	QTY
	1	7-100734-ZZ	ASM, RT ARC SPOUT, ART DECO <i>(incl. 1.5)</i>	1
	1.5	880249-81	INSERT, STD, NEOSTRAHL FULL FLOW - CACHE	1
for ITEM 1	2	87093-80	O-RING Ø44.17 X 1.78 (-031) BUNA-N A70	1
	3	880392-98	NIPPLE, 3/4 NPT/NPSM X 4-1/8" X 3/4" SWEAT	1
	4	223469-99	CUP SPACER, STEEL, DIE CHROME, R/T, 22 SERIES	1
	5	881253-99	WSHR 1"-20 SHANK - SS	1
	6	882805-99	FLANGE NUT, 3/4"-14 NPSM X 1.68 OD X .30 HT	1
	7	11489-ZZ	ESCUTCHEON, BEVEL ART DECO	2
	8	87340-81	WSHR Ø.590" X Ø.390" X .030" BLK UHMW	2
for 8708A Series	9	7-100727-ZZ	ASM, HANDLE, ART DECO LEVER <i>(incl. 9.4, 9.5, 9.6)</i>	2
	9.4	86047-90	SETScrew 10-24 X 3/16 SCKT HD CONE PT SS	1
	9.5	10444-ZZ	CAP, HANDLE SCRw	1
	9.6	87321-80	O-RING Ø2.80 X 1.90 (NA) BUNA-N A70	1
for 8708A-BG Series	10	7-100727-BG-ZZ	ASM, HANDLE, ART DECO LEVER, BLACK GLASS <i>(incl. 9.4, 9.5, 9.6)</i>	2
for 8708A-BKS Series	11	7-100727-BKS-ZZ	ASM, HANDLE, ART DECO LEVER, BLACK MARBLE <i>(incl. 9.4, 9.5, 9.6)</i>	2
for 8708A-WS Series	12	7-100727-WS-ZZ	ASM, HANDLE, ART DECO LEVER, WHITE MARBLE <i>(incl. 9.4, 9.5, 9.6)</i>	2
for 8708A-RS Series	13	7-100727-RS-ZZ	ASM, HANDLE, ART DECO LEVER, RED JASPER <i>(incl. 9.4, 9.5, 9.6)</i>	2
for 8708A-GS Series	14	7-100727-GS-ZZ	ASM, HANDLE, ART DECO LEVER, GREEN AVENTURINE <i>(incl. 9.4, 9.5, 9.6)</i>	2
for 8708A-BS Series	15	7-100727-BS-ZZ	ASM, HANDLE, ART DECO LEVER, BLUE SODALITE <i>(incl. 9.4, 9.5, 9.6)</i>	2
for 8708A-TES Series	16	7-100727-TES-ZZ	ASM, HANDLE, ART DECO LEVER, TIGER EYE <i>(incl. 9.4, 9.5, 9.6)</i>	2