

△ REQUIRES ITEM 14

3902AH **3902A**
3902AP **3902AK**
3902API **3902AR**
3902ARI

To order spare parts add and/or replace as stated below:

SPD- prefix added to part number(s)
-ZZ replaced with finish code (see finish table)
-WW replaced with **-90** (light finish) or **-96** (dark finish)

Ex: **SPD-7-100463-PC** or **SPD-86030-96**

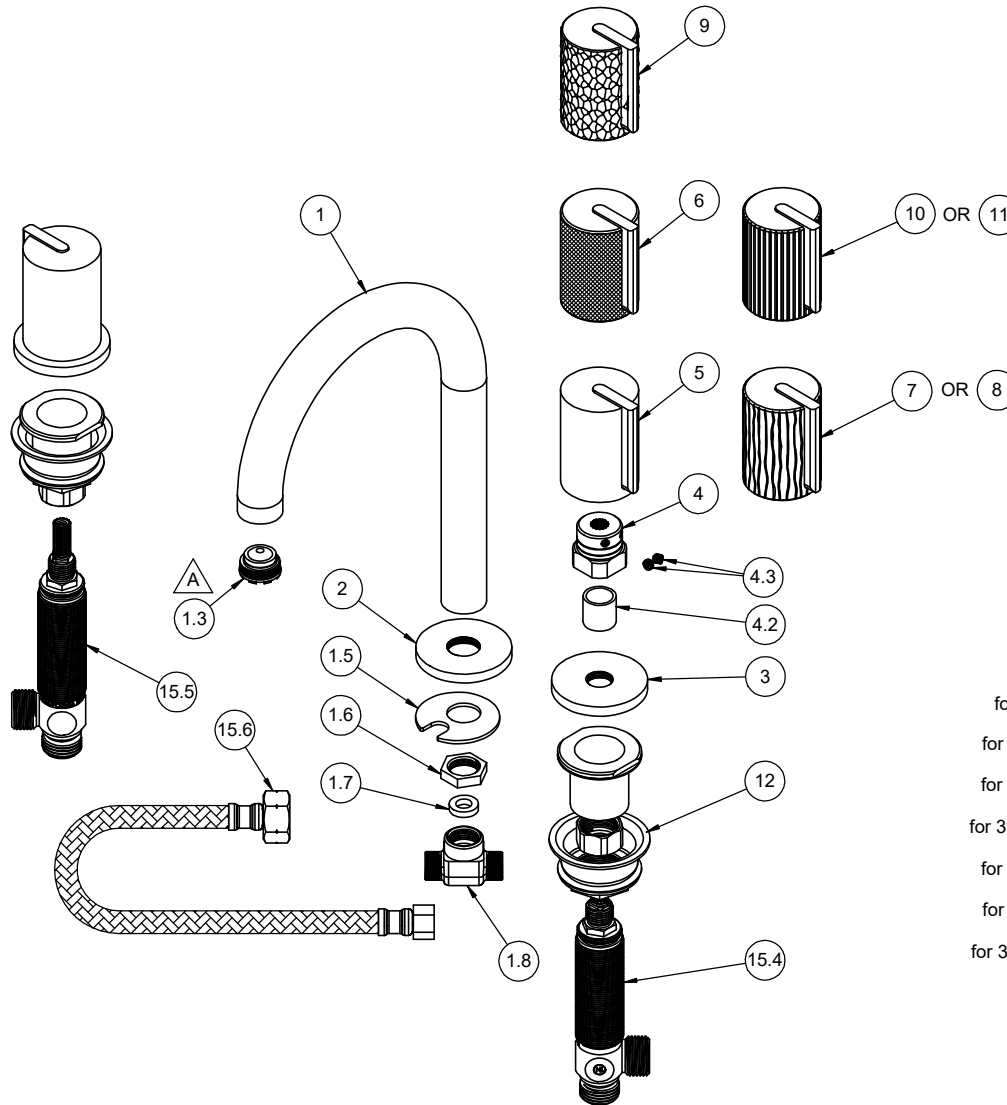

ITEM	PART NO.	DESCRIPTION	QTY
1	7-100725-ZZ	ASM, CANE LAV SPOUT, Ø24MM (incl. 1.3, 1.5, 1.6, 1.7, 1.8)	1
1.3	880648-81	INSERT, JUNIOR, 1.2 GPM CACHE AERATED	1
1.5	881766-99	WSHR HORSESHOE	1
1.6	881276-99	NUT, HEX 3/8"-18 NPSM X .20 HT	1
1.7	87162-80	WSHR Ø8.5 X Ø15.5 X 3.5MM EPDM A70 (NSF-61-12 & WRAS)	1
1.8	880083-90	TEE, 3-WAY LAV - SS	1
2	11089-ZZ	ESCUTCHEON, RD Ø2" W/ M18 X 1.0	1
3	11090-ZZ	ESCUTCHEON, RD Ø2" W/ 9/16"-20	2
4	6-200327	ASM, CYL HDL CARRIER (incl. 4.2, 4.3)	2
4.2	87342-81	BUSHING, Ø14.30 X Ø17.50 X 16.70MM UHMW	1
4.3	86033-90	SETSCREW 10-24 X 3/16 SCKT HD CUP PT SS	2
for 39A Series	5	7-100594-ZZ ASM, SMOOTH CYL HDL	2
for 39AK Series	6	7-100596-ZZ ASM, KNURL CYL HDL	2
for 39AR Series	7	7-100597-ZZ ASM, RIVULET CYL HDL	2
for 39ARI Series	8	7-100597I-ZZ ASM, RIVULET CYL HDL - INTAGLIO	2
for 39AH Series	9	7-100598-ZZ ASM, HAMMERED CYL HDL	2
for 39AP Series	10	7-100606-ZZ ASM, PINSTRIPE CYL HDL	2
for 39API Series	11	7-100606I-ZZ ASM, PINSTRIPE CYL HDL - INTAGLIO	2
	12	6-200294 KIT, W/S INV NUT - 2 SETS (1 SET= 6-200294-1)	2
for ITEM 4.3	13	882043-99 KEY, ALLEN, 3/32", BLACK	1
for ITEM 1.3	14	223472-99 KEY, TT CACHE AERATOR INSERT	1
	15.4	6-200087 ASM, COLD-LAV "NL" BODY & CART (.25 Pb)-G4 (incl. CART-WS-LTC)	1
	15.5	6-200088 ASM, HOT-LAV "NL" BODY, CART (.25 Pb)-G4 (incl. CART-WS-RTC)	1
	15.6	880099-99 HOSE, POLY BRAIDED, 1/2 IPS X 3/8 CMP X 12 (DN6-SILICONE) (NL, NSF-61-12 & WRAS)	1

