

A REQUIRES ITEM (51.2)

B REQUIRES ITEM (53)

C REQUIRES ITEM (1.7)

D for 39, 39K, 39P, 39R, 39H, 39RI, 39PI, 52, 52F, 52K, 53, 53F, 53K, 62, 65, 66, 70, 77, E4 & E5 Series

E for 37, 37T, 37XT, 40, 40X, 45, 45X, 74, E3 & 41 Series

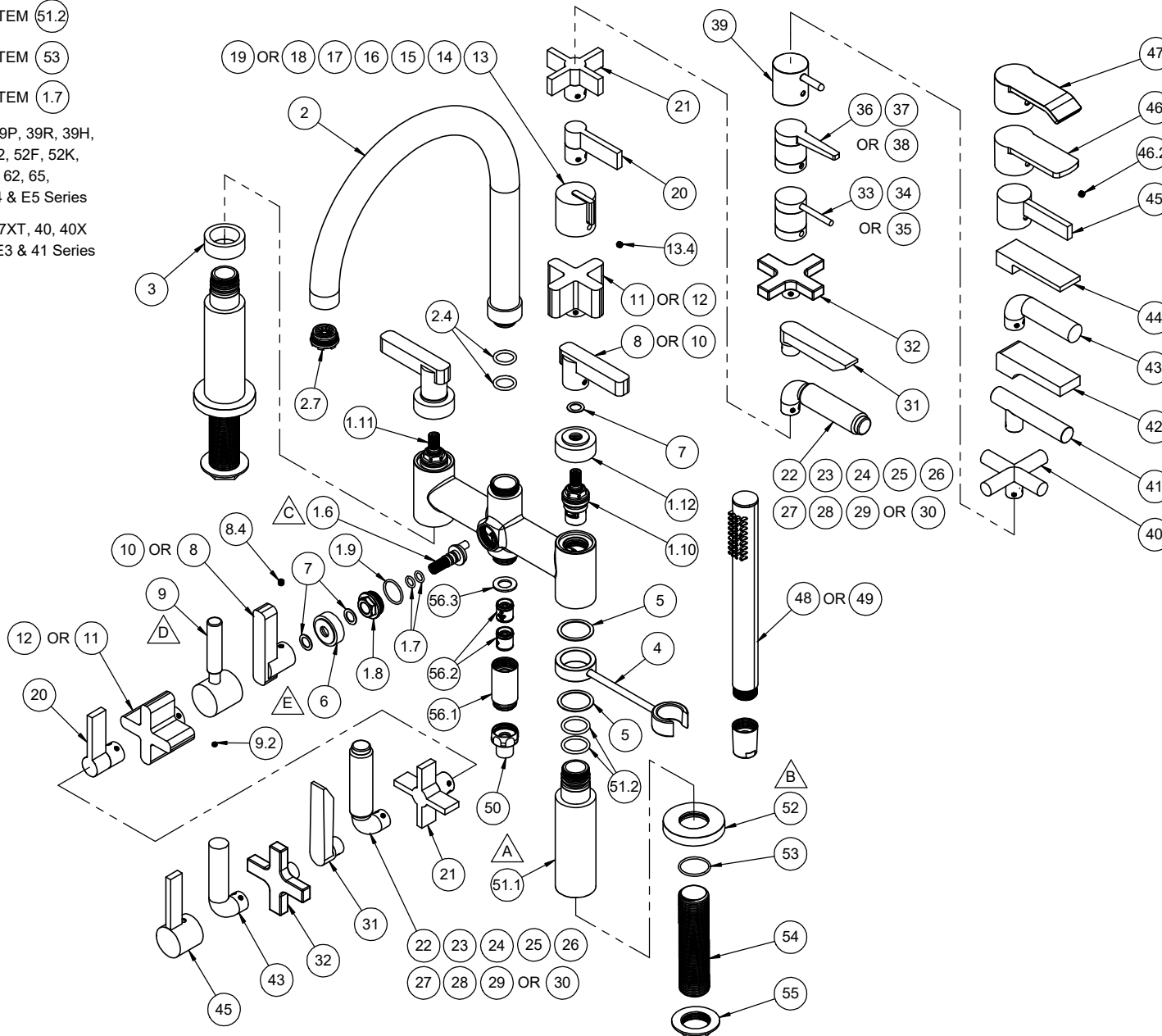

- 1108-37.FR
- 1108-37T.FR
- 1108-37X.FR
- 1108-37XT.FR
- 1108-39.FR
- 1108-39K.FR
- 1108-39P.FR
- 1108-39R.FR
- 1108-39H.FR
- 1108-39PI.FR
- 1108-39RI.FR
- 1108-40.FR
- 1108-40X.FR
- 1108-41.FR
- 1108-41-WP.FR
- 1108-41-ADC.FR
- 1108-41-BP.FR
- 1108-41-GP.FR
- 1108-41-OP.FR
- 1108-41-PP.FR
- 1108-41-RD.FR
- 1108-41-YP.FR
- 1108-45.FR
- 1108-45X.FR
- 1108-52.FR
- 1108-52F.FR
- 1108-52K.FR
- 1108-53.FR
- 1108-53F.FR
- 1108-53K.FR
- 1108-62.FR
- 1108-65.FR
- 1108-66.FR
- 1108-70.FR
- 1108-74.FR
- 1108-77.FR
- 1108-E3.FR
- 1108-E4.FR
- 1108-E5.FR

	ITEM	PART NO.	DESCRIPTION	QTY
for 39H series	17	7-100617-ZZ	ASM, HAMMERED SMALL CYL HDL <i>(incl. 13.4)</i>	2
for 39PI series	18	7-100618I-ZZ	ASM, PINSTRIPE SMALL CYL HDL - INTAGLIO <i>(incl. 13.4)</i>	2
for 39RI series	19	7-100616I-ZZ	ASM, RIVULET SMALL CYL HDL - INTAGLIO <i>(incl. 13.4)</i>	2
for 40 series	20	7-100654-ZZ	ASM, SHORT BLADE LEVER HDL <i>(incl. 9.2)</i>	3
for 40X series	21	7-100656-ZZ	ASM, SHORT BLADE CROSS HDL <i>(incl. 9.2)</i>	3
for 41 series	22	7-100697-ZZ	ASM, BRS LEVER HDL, 41 SERIES <i>(incl. 9.2)</i>	3
for 41-ADC series	23	7-100697-ADC-ZZ	ASM, BRS LEVER HDL, ADC, 41 SERIES <i>(incl. 9.2)</i>	3
for 41-RD series	24	7-100697-RD-ZZ	ASM, BRS LEVER HDL, RED, 41 SERIES <i>(incl. 9.2)</i>	3
for 41-WP series	25	7-100698-WP-ZZ	ASM, PORC LEVER HDL, WHITE, 41 SERIES <i>(incl. 9.2)</i>	3
for 41-PP series	26	7-100698-PP-ZZ	ASM, PORC LEVER HDL, PINK, 41 SERIES <i>(incl. 9.2)</i>	3
for 41-GP series	27	7-100698-GP-ZZ	ASM, PORC LEVER HDL, GREEN, 41 SERIES <i>(incl. 9.2)</i>	3
for 41-OP series	28	7-100698-OP-ZZ	ASM, PORC LEVER HDL, ORANGE, 41 SERIES <i>(incl. 9.2)</i>	3
for 41-YP series	29	7-100698-YP-ZZ	ASM, PORC LEVER HDL, YELLOW, 41 SERIES <i>(incl. 9.2)</i>	3
for 41-BP series	30	7-100698-BP-ZZ	ASM, PORC LEVER HDL, BLUE, 41 SERIES <i>(incl. 9.2)</i>	3
for 45 series	31	7-100135-ZZ	ASM, LEVER HANDLE - ART DECO <i>(incl. 9.2)</i>	3
for 45X series	32	7-100267-ZZ	ASM, SQ. CROSS HDL <i>(incl. 9.2)</i>	3
for 52 series	33	7-100506-ZZ	ASM, STICK HDL W/SMOOTH CYL - THERM <i>(incl. 8.4)</i>	2
for 52F series	34	7-100507-ZZ	ASM, STICK HDL W/C. FIBER CYL - THERM <i>(incl. 8.4)</i>	2
for 52K series	35	7-100508-ZZ	ASM, STICK HDL W/KNURLED CYL - THERM <i>(incl. 8.4)</i>	2
for 53 series	36	7-100509-ZZ	ASM, TANG HDL W/SMOOTH CYL - THERM <i>(incl. 8.4)</i>	2
for 53F series	37	7-100510-ZZ	ASM, TANG HDL W/C. FIBER CYL - THERM <i>(incl. 8.4)</i>	2
for 53K series	38	7-100511-ZZ	ASM, TANG HDL W/KNURLED CYL - THERM <i>(incl. 8.4)</i>	2
for 62 series	39	7-623179-ZZ	KIT, LEV HDL, 62 SERIES <i>(incl. 9.2)</i>	2
for 65 series	40	7-653143-ZZ	KIT, CTEMP CROSS HDL, 65 SERIES <i>(incl. 9.2)</i>	2
for 66 series	41	7-663144-ZZ	KIT, CTEMP LEV HDL, 66 SERIES <i>(incl. 9.2)</i>	2
for 70 series	42	7-100320-ZZ	ASM, LEVER, 70 SERIES "BROACHED" <i>(incl. 9.2)</i>	2
for 74 series	43	7-100146-ZZ	ASM, LEVER, 74 SERIES "BROACHED" <i>(incl. 9.2)</i>	3
for 77 series	44	7-100259-ZZ	ASM, LEVER, 77 SERIES "BROACHED" <i>(incl. 9.2)</i>	2
for E3 series	45	7-100319-ZZ	ASM, HANDLE, RD HUB SHORT & BLADE LEVER <i>(incl. 13.4)</i>	3
for E4 series	46	7-100260-ZZ	ASM, LEVER, E4 SERIES <i>(incl. 46.2)</i>	2
	46.2	86136-90	SETSCREW M5X0.8 X 5MM SCKT HD CONE PT SS	1

To order spare parts add and/or replace as stated below:

SPD- prefix added to part number(s)
-ZZ replaced with finish code (see finish table)
-WW replaced with **-90** (light finish) or **-96** (dark finish)

Ex: **SPD-7-100463-PC** or **SPD-86030-96**

ITEM	PART NO.	DESCRIPTION	QTY
1.6	10463-98	STEM, DIVERTER, 16 SERIES	1
1.7	87006-80	O-RING Ø7.65 X 1.78 (-011) BUNA-N A70 (NSF-61-12)	2
1.8	10404-98	NUT, DIVERTER STEM, 16 SERIES	1
1.9	87233-80	O-RING Ø20.35 X 1.78 (-019) NBR A70 (NSF61-12 & WRAS)	1
1.10	880431-99	CART 1/2" 16-T W/FRICTION BRG M24X1 MALE THD - LTC "NL"	1
1.11	880430-99	CART 1/2" 16-T W/FRICTION BRG M24X1 MALE THD - RTC "NL"	1
1.12	10390-ZZ	CAP, CARTRIDGE	2
2	7-100162-ZZ	ASM, SPOUT, EXP TUB - CONT RD <i>(incl. 2.4, 2.7)</i>	1
2.4	87225-80	O-RING Ø15.54 X 2.62 (-114) EPDM A70 (NSF61-12 & WRAS)	2
2.7	880249-81	INSERT, STD, NEOSTRAHL FULL FLOW - CACHE	1
3	10392-ZZ	SPACER, HOOK	1
4	10572-ZZ	HOOK, HANDSHOWER, TUB FILLER C-C 4.66"	1
5	87099-81	WSHR Ø1.02" X Ø1.26" X .03" UHMW BLK	2
6	10848-ZZ	CAP, DIVERTER, CONT EXP TUB	1
7	87340-81	WSHR Ø.590" X Ø.390" X .030" BLK UHMW	4
8	7-100611-ZZ	ASM, RND SQ THERM HDL <i>(incl. 8.4)</i>	3
8.4	86033-WW	SETSCREW 10-24 X 3/16 SCKT HD CUP PT SS	1
9	7-100164-ZZ	ASM, DIV HDL, EXP TUB - CONT <i>(incl. 9.2)</i>	1
9.2	86030-WW	SETSCREW 8-32 X 1/8 SCKT HD CUP PT SS	1
10	7-100611T-ZZ	ASM, RND SQ THERM HDL - TEAK <i>(incl. 8.4)</i>	3
11	7-100593-ZZ	ASM, 37 SERIES CROSS HDL <i>(incl. 8.4)</i>	3
12	7-100593T-ZZ	ASM, 37 SERIES CROSS HDL - TEAK <i>(incl. 8.4)</i>	3
13	7-100613-ZZ	ASM, SMOOTH SMALL CYL HDL <i>(incl. 13.4)</i>	2
13.4	86047-90	SETSCREW 10-24 X 3/16 SCKT HD CONE PT SS	1
14	7-100615-ZZ	ASM, KNURL SMALL CYL HDL <i>(incl. 13.4)</i>	2
15	7-100618-ZZ	ASM, PINSTRIPE SMALL CYL HDL <i>(incl. 13.4)</i>	2
16	7-100616-ZZ	ASM, RIVULET SMALL CYL HDL <i>(incl. 13.4)</i>	2

E

for 37 series

D

for 37T series

for 37X series

for 37XT series

for 39 series

for 39K series

for 39P series

for 39R series

To order spare parts add and/or replace as stated below:

SPD- prefix added to part number(s)

-ZZ replaced with finish code (see finish table)

-WW replaced with **-90** (light finish) or **-96** (dark finish)

Ex: **SPD-7-100463-PC** or **SPD-86030-96**

	ITEM	PART NO.	DESCRIPTION	QTY
for E5 series	47	7-100367-ZZ	ASM, LEVER, E5 SERIES <i>(incl. 46.2)</i>	2
	48	5-100061.18-ZZ	ASM, HS-62 W/1.8 FLOW RESTRICTOR - G3	1
	49	5-100061.20-ZZ	ASM, HS-62 W/2.0 FLOW RESTRICTOR - G3	1
	50	5-100129-57-ZZ	ASM, 57" HANDSHWR HOSE	1
	51	7-100169-ZZ	ASM, LEG, DECK MNT, EXP TUB <i>(incl. 51.1, 51.2)</i>	2
	51.1	10388-ZZ	LEG, EXPOSED TUB DECK, CONT.	1
	51.2	912831-99	O-RING 20.29 X 2.62 (-117) BUNA-N A70	2
	52	50903-ZZ	BASE RING, RD, SWIVEL HNDSHWR	2
	53	87204-80	O-RING Ø25.12 X 1.78 (-022) EPDM A70 (NSF-61 & WRAS)	2
	54	880392-98	NIPPLE, 3/4 NPT/NPSM X 4-1/8" X 3/4" SWEAT	2
	55	882805-99	FLANGE NUT, 3/4"-14 NPSM X 1.68 OD X .30 HT	2
	56	7-100182-ZZ	ASM, IN-LINE DUAL CHECK 1/2"FIP X 1/2"MIP - CONT <i>(incl. 56.1, 56.2, 56.3)</i>	1
	56.1	10597-ZZ	HOUSING, DUAL CHECK 1/2"FIP X 1/2"MIP - CONT	1
	56.2	880319-81	CHECK VALVE, CV15 FULL FLOW - WHITE	2
	56.3	87167-80	WSHR, Ø12.00 X Ø21.00 X 1.50MM EPDM A70 (WRAS)	1
for ITEM 2.7	60	223473-99	KEY, STD CACHE AERATOR INSERT	1
for ITEM 9.2	61	882042-99	KEY, ALLEN, 5/64", BLACK	1
for ITEM 8.4, 13.4	62	882043-99	KEY, ALLEN, 3/32", BLACK	1
for ITEM 46.2	70	880007-91	KEY, ALLEN, 2.5MM	1