



California Faucets®

Tub Filler™

Retrofit kit for Single-Hole Floor Mount Tub Filler

9511R

Features

- For use on all 9511 roughs shipped prior to Dec. 15, 2025
- Permits the installation of Single-Hole Tub Filler Faucet on early generation of 9511 Rough Valve
- Includes all necessary hardware to install

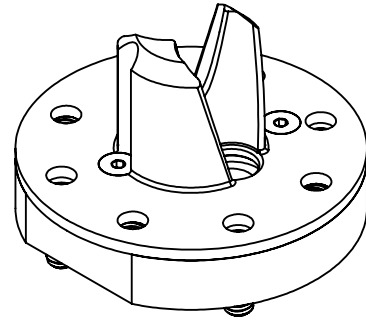

IMPORTANT: A decorative Extension Base Ring, (SPD-11513-ZZ) may be required based on the finish floor height in relation to the installed 9511 rough top surface. Refer to the images below to see if an extension ring is needed. (ZZ = Finish)

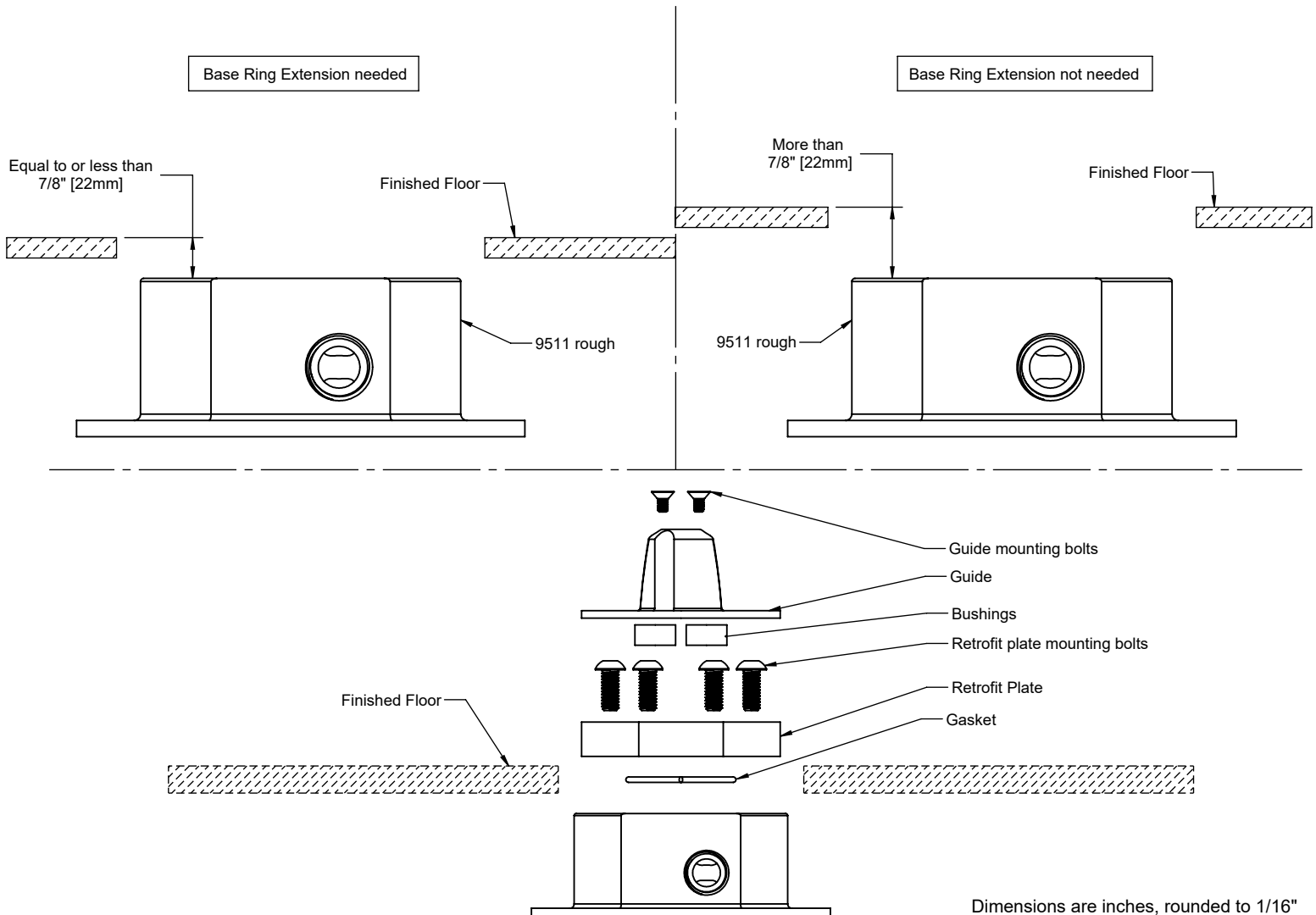

Specifications subject to change without notice

Dimensions are inches, rounded to 1/16"
[Dimensions in brackets are mm, rounded to 1mm]